



# Transfer Case Parts

Ford

Mercury

Lincoln

| TRANSFER CASE | TYPE  |         | SERIES | PAGE |
|---------------|-------|---------|--------|------|
| BW1345        | 2 SPD | 4WD     | TC1345 | 2    |
| BW1350        | 2 SPD | 4WD     | TC1350 | 4    |
| BW1354        | 2 SPD | 4WD     | TC1354 | 8    |
| BW1356        | 2 SPD | 4WD     | TC1356 | 12   |
| BW1359        | NONE  | 2WD     | TC1359 | 14   |
| BW4403        | AWD   | 4WD     | TC4403 | 15   |
| BW4404        | 1 SPD | 4WD     | TC4404 | 16   |
| BW4405        | 2 SPD | 4WD     | TC4405 | 18   |
| BW4406        | 2 SPD | 4WD     | TC4406 | 20   |
| BW4407        | 2 SPD | 4WD     | TC4407 | 22   |
| BW4410        | 1 SPD | 4WD/AWD | TC4410 | 24   |
| BW4411        | 2 SPD | 4WD/AWD | TC4411 | 26   |
| BW4416        | 2 SPD | 4WD     | TC4416 | 28   |
| NP203F        | 2 SPD | 4WD     | TC203F | 30   |
| NP205F        | 2 SPD | 4WD     | TC205F | 34   |
| NP208F        | 2 SPD | 4WD     | TC208F | 36   |
| NV271F        | 2 SPD | 4WD     | TC271F | 38   |
| NV273F        | 2 SPD | 4WD     | TC273F | 40   |
| Dana 20F      | 2 SPD | 4WD     | TC20F  | 42   |
| Dana-21       | 2 SPD | 4WD     | TC21   | 44   |
| Dana 24       | 2 SPD | 4WD     | TC24   | 45   |
| DanaModel-28  | 2 SPD | 4WD     | TC28   | 46   |



TKC-0011  
course  
Time-Sert®  
Master Kit (USS)  
Includes 1/4-20  
5/16-18/3/8-16  
7/16-14/1/2-13  
(20 each inserts)



TKC-0021  
fine  
Time-Sert®  
Master Kit (SAE)  
Includes 1/4-28  
5/16-24/3/8-24  
7/16-20/1/2-20  
(20 each inserts)



TKC-1002  
course  
Time-Sert®  
Master Kit  
(Metric USS)  
Includes M5x0.8  
M6x1.0/M8x1.25  
M10x1.5mm  
M12x1.75mm  
(20 each inserts)



TKC-1003  
fine  
Time-Sert®  
Master Kit  
(Metric)  
Includes M5x0.8  
M6x1.0/M8x1.25  
M10x1.5mm  
M12x1.75mm  
(20 each inserts)

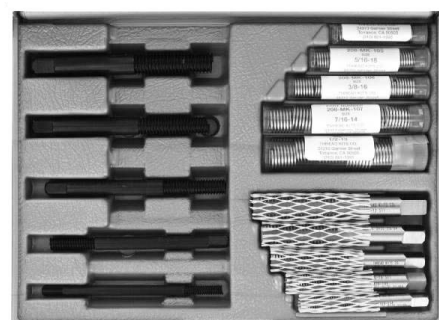

TKC-1208-CMK  
course  
Master Kit  
(USS coarse)  
Includes inserts  
installation tools  
taps (1/4-20  
5/16-18/3/8-16  
7/16-14/1/2-13)

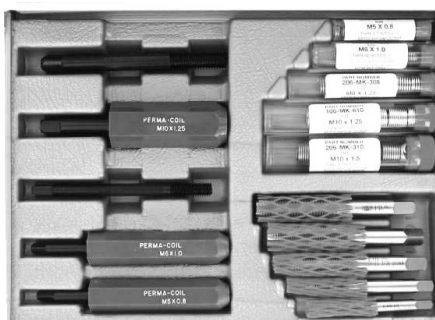

TKC-1221-MMK  
course  
Master Kit (metric)  
Includes inserts  
installation tools  
taps (5x0.8  
6x1.0/8x1.25  
10x1.25mm  
10x1.5mm)

# VEHICLE TO TRANSMISSION INDEX

INDEX

| MODEL NAME                | ENGINE            | YEAR  | TRANSFER CASE | PAGE |
|---------------------------|-------------------|-------|---------------|------|
| <b>FORD/PICKUP</b>        |                   |       |               |      |
| Aerostar                  | V/6 3.0L          | 90-97 | DanaModel-28  | 46   |
| Bronco                    | various           | 66-77 | Dana 20F      | 42   |
| Bronco                    | various           | 78-79 | NP205F        | 34   |
| Bronco                    | various           | 80-86 | NP208F        | 36   |
| Bronco                    | various           | 87-93 | BW1356        | 12   |
| Bronco II                 | various           | 83-93 | BW1350        | 4    |
| Bronco II                 | V/6 2.9L          | 84-90 | BW1359        | 14   |
| Early trucks/vans/suv's   | various           | 62-72 | Dana 24       | 45   |
| Early trucks/vans/suv's   | various           | 71-89 | NP205F        | 34   |
| Early trucks/vans/suv's   | various           | 72-79 | NP203F        | 30   |
| Early trucks/vans/suv's   | various           | 74-76 | Dana-21       | 44   |
| Econoline 250             | various           | 87-97 | BW1356        | 12   |
| Econoline 250/250 SD      | various           | 99-08 | NV271F        | 38   |
| Econoline 250/250 SD      | various           | 99-08 | NV273F        | 40   |
| Econoline 350             | various           | 87-97 | BW1356        | 12   |
| Econoline 350 SD          | various           | 99-08 | NV271F        | 38   |
| Excursion                 | various           | 99-08 | NV273F        | 40   |
| Expedition                | various           | 97-02 | BW4406        | 20   |
| Expedition                | various           | 01-05 | BW4416        | 28   |
| Explorer                  | various           | 91-99 | BW1354        | 8    |
| Explorer                  | various           | 95-01 | BW4405        | 18   |
| Explorer                  | various           | 96-03 | BW4404        | 16   |
| Explorer                  | various           | 99-01 | BW4403        | 15   |
| Explorer                  | 5.0L V/8          | 02-06 | BW4410        | 24   |
| Explorer                  | 4.0L V/6          | 02-06 | BW4411        | 26   |
| Explorer Sport/Sport Trac | various           | 00-05 | BW1354        | 8    |
| F-100                     | various           | 03-04 | BW4416        | 28   |
| F-150                     | various           | 80-91 | BW1345        | 2    |
| F-150                     | various           | 80-86 | NP208F        | 36   |
| F-150                     | various           | 87-96 | BW1356        | 12   |
| F-150                     | various           | 97-04 | BW4406        | 20   |
| F-150                     | various           | 03-04 | BW4416        | 28   |
| F-250                     | various           | 80-91 | BW1345        | 2    |
| F-250                     | various           | 80-86 | NP208F        | 36   |
| F-250                     | various           | 96-97 | BW4404        | 16   |
| F-250                     | L/6 4.9L V/8 7.5L | 96-97 | BW4407        | 22   |
| F-250                     | various           | 97-99 | BW4406        | 20   |
| F-250                     | various           | 99-08 | NV271F        | 38   |
| F-250 Super Duty          | various           | 99-08 | NV271F        | 38   |
| F-250/250 Super Duty      | various           | 99-08 | NV273F        | 40   |
| F-350                     | various           | 80-87 | BW1345        | 2    |
| F-350                     | various           | 80-86 | NP208F        | 36   |
| F-350                     | various           | 96-97 | BW4404        | 16   |
| F-350                     | V/8 7.3L          | 96-97 | BW4407        | 22   |
| F-350                     | various           | 99-08 | NV271F        | 38   |
| F-350 Super Duty          | various           | 99-08 | NV271F        | 38   |
| F-350/350 Super Duty      | various           | 99-08 | NV273F        | 40   |
| F-450/550 Super Duty      | various           | 99-08 | NV271F        | 38   |
| Ranger                    | various           | 83-93 | BW1350        | 4    |
| Ranger                    | various           | 91-98 | BW1354        | 8    |
| <b>LINCOLN</b>            |                   |       |               |      |
| Navigator                 | various           | 99-02 | BW4406        | 20   |
| Navigator                 | various           | 01-05 | BW4416        | 28   |

# VEHICLE TO TRANSMISSION INDEX

| MODEL NAME     | ENGINE   | YEAR  | TRANSFER CASE | PAGE |
|----------------|----------|-------|---------------|------|
| <b>MERCURY</b> |          |       |               |      |
| Mountaineer    | various  | 97-03 | BW4404        | 16   |
| Mountaineer    | various  | 99-01 | BW4403        | 15   |
| Mountaineer    | 5.0L V/8 | 02-06 | BW4410        | 24   |
| Mountaineer    | 4.0L V/6 | 02-06 | BW4411        | 26   |



**TKC-1208-FMK**  
fine  
Time-Sert®  
Master Kit (SAE)  
Includes (1/4-28  
5/16-24/3/8-24  
7/16-20/1/2-20)



**TKC-0140**  
1/4-20  
Inch Repair Kit  
Time-Sert®  
Includes drill bit  
counter bore/tap  
installation driver  
(5 inserts)



**TKC-0561**  
5/16-18  
Inch Repair Kit  
Time-Sert®  
Includes drill bit  
counter bore/tap  
installation driver  
(5 inserts)



**TKC-1012**  
M10x1.25  
Metric Repair Kit  
Time-Sert®  
Includes drill bit  
counter bore/tap  
installation driver  
(5 inserts)

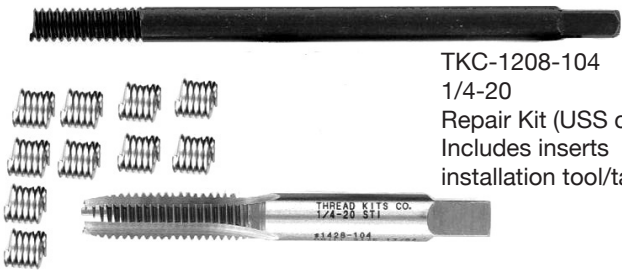

**TKC-1208-104**  
1/4-20  
Repair Kit (USS coarse)  
Includes inserts  
installation tool/tap

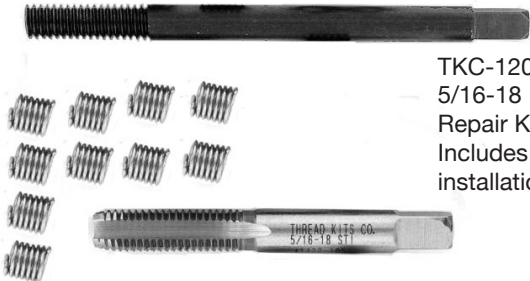

**TKC-1208-105**  
5/16-18  
Repair Kit (USS coarse)  
Includes inserts  
installation tool/tap

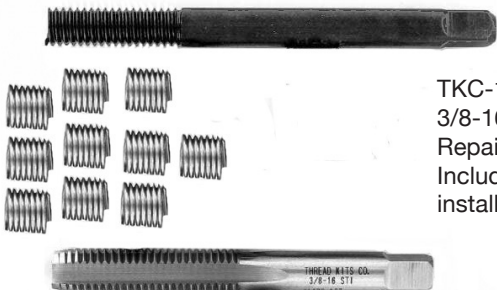

**TKC-1208-106**  
3/8-16Kit  
Repair Kit (USS coarse)  
Includes inserts  
installation tool/tap



**TKC-1208-107**  
7/16-14  
Repair Kit (USS coarse)  
Includes inserts  
installation tool/tap



# BW1345•1345

BW1345

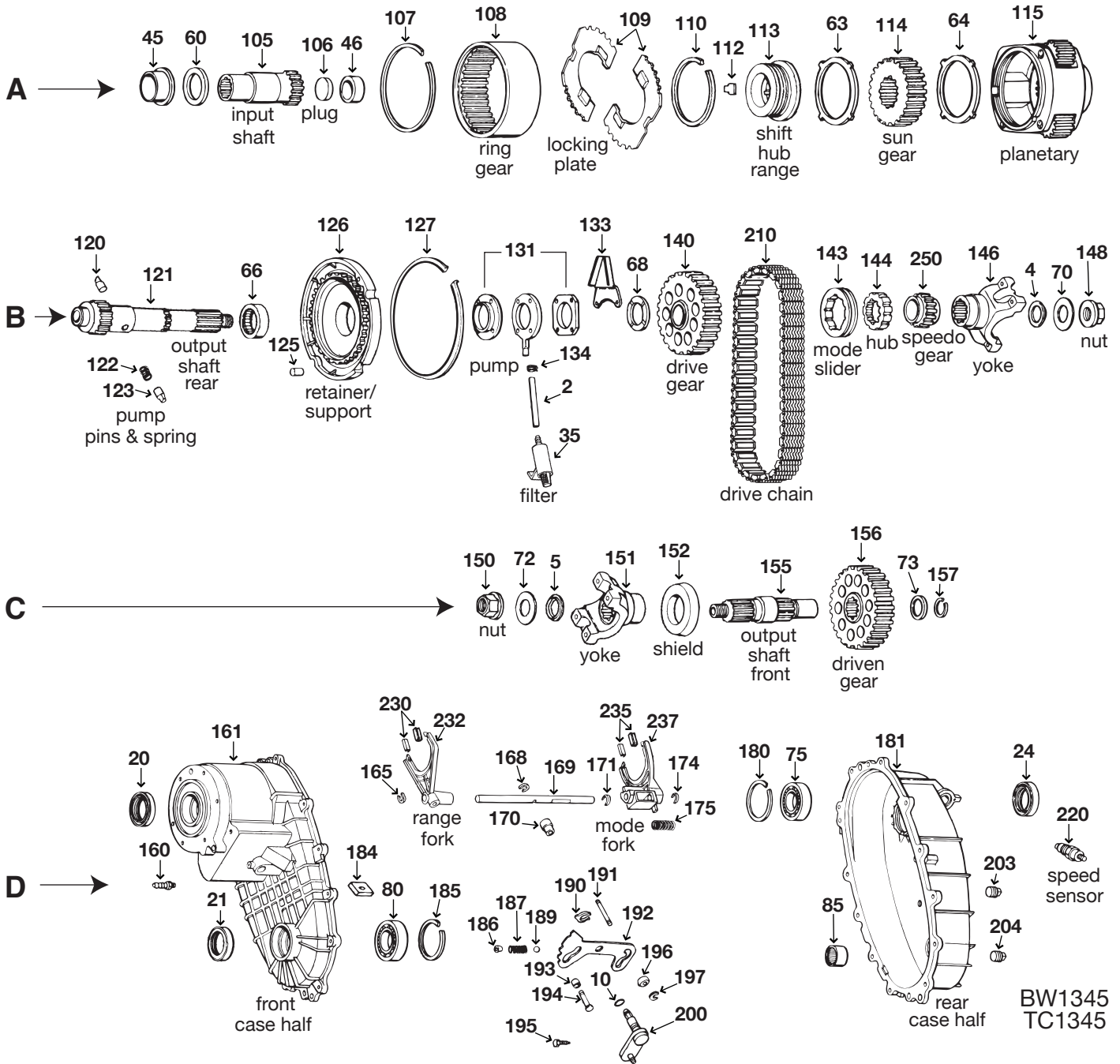

BW1345  
TC1345

| ILL                                  | DESCRIPTION              | QTY | YEAR  | REFERENCE #  | PART #            |
|--------------------------------------|--------------------------|-----|-------|--------------|-------------------|
| <b>REBUILDER KITS</b>                |                          |     |       |              |                   |
| n/i                                  | Kit, bearing/gasket/seal | 1   | 80-91 | AE           | <b>TK-1345</b>    |
| n/i                                  | Kit, gasket/seal         | 1   | 80-91 | AE           | <b>K105-910</b>   |
| <b>GASKETS AND RUBBER COMPONENTS</b> |                          |     |       |              |                   |
| B2                                   | Hose, oil pump           | 1   | 80-91 | n/a          | <b>TC1356-203</b> |
| n/i                                  | Gasket, adapter housing  | 1   | 80-91 | 04130678     | <b>13591</b>      |
| <b>METAL CLAD SEALS</b>              |                          |     |       |              |                   |
| D20                                  | Seal, metal clad         | 1   | 80-91 | E3TZ-7B215-H | <b>205-17502</b>  |
| D21                                  | Seal, metal clad         | 1   | 80-91 | E0TZ-7B215-B | <b>205-18662</b>  |
| D24                                  | Seal, metal clad         | 1   | 80-91 | n/a          | <b>205-18994</b>  |
| <b>FILTERS</b>                       |                          |     |       |              |                   |
| B35                                  | Filter, oil pump         | 1   | 80-91 | n/a          | <b>TC1356-050</b> |
| <b>BUSHINGS</b>                      |                          |     |       |              |                   |
| A45                                  | Bushing                  | 1   | 80-91 | n/a          | <b>TC1345-160</b> |





| ILL                                  | DESCRIPTION                             |                                   | QTY | YEAR  | REFERENCE #   | PART #        |
|--------------------------------------|---|-----------------------------------|-----|-------|---------------|---------------|
| <b>REBUILDER KITS</b>                |   |                                   |     |       |               |               |
| K37                                  | Kit, bearing/gasket/seal                | manual/electric shift             | 1   | 83-93 | AE            | TK-1350       |
| K37                                  | Kit, gasket/seal                        | manual/electric shift             | 1   | 83-93 | AE            | K105-915      |
| <b>GASKETS AND RUBBER COMPONENTS</b> |   |                                   |     |       |               |               |
| A3                                   | Hose, oil pump                          | BW1350                            | 1   | 83-93 | 1356-034-001  | TC1356-203    |
| n/i                                  | Gasket, adapter                         | adapter housing to transfer case  | 1   | 83-93 | M353317A      | 13594         |
| <b>METAL CLAD SEALS</b>              |   |                                   |     |       |               |               |
| A25                                  | Seal, metal clad                        | front input shaft                 | 1   | 83-93 | E3TZ-7B215-H  | 205-17502     |
| E28                                  | Seal, metal clad                        | front output shaft (manual shift) | 1   | 83-93 | E3TZ-7B215-D  | 205-15900     |
| E28                                  | Seal, metal clad                        | front output shaft                | 1   | 83-93 | F3TZ-7B215-A  | 205-16043     |
| E30                                  | Seal, metal clad                        | shift shaft                       | 1   | 83-93 | 1300-044-001  | TC1350-140    |
| E33                                  | Seal, metal clad                        | rear output shaft                 | 1   | 83-93 | F3TZ-7B215-A  | 205-16043     |
| <b>FILTERS</b>                       |   |                                   |     |       |               |               |
| A40                                  | Filter, oil pump                        | BW1350                            | 1   | 83-93 | E0TZ-7A098-AA | TC1356-050    |
| <b>BUSHINGS</b>                      |   |                                   |     |       |               |               |
| A45                                  | Bushing                                 | front input shaft (rear)          | 1   | 83-93 | n/a           | TC1350-159    |
| <b>WASHERS/BEARINGS/RACES/SHIMS</b>  |   |                                   |     |       |               |               |
| A55                                  | Bearing, ball .628" 1.773" id 2.950" od | front input shaft (front)         | 1   | 83-93 | E3TZ-7025-B   | 6009N         |
| A58                                  | Washer, thrust                          | sun gear (front)                  | 1   | 83-93 | E3TZ-7B066-A  | TC1350-132    |
| A60                                  | Bearing, caged (cup)                    | front input shaft (middle)        | 1   | 83-93 | BCE-1816      | TC1350-135    |
| A64                                  | Bearing, ball .628" 1.180" id 2.435" od | output shaft (middle)             | 1   | 83-93 | E3TZ-7025-A   | 6206N         |
| C68                                  | Bearing, ball .628" 1.180" id 2.435" od | output shaft (middle)             | 1   | 83-93 | E3TZ-7025-A   | 6206N         |
| D75                                  | Bearing, ball .590" 1.573" id 2.675" od | front output shaft (front)        | 1   | 83-93 | E3TZ-7025-C   | 6008-J        |
| E80                                  | Bearing, ball .628" 1.180" id 2.435" od | output shaft (rear)               | 1   | 83-93 | E3TZ-7025-A   | 6206N         |
| E87                                  | Bearing, caged (open)                   | shift shaft                       | 1   | 83-93 | 1300-127-002  | TC1350-134    |
| E88                                  | Bearing, caged (cup)                    | output shaft (rear)               | 1   | 83-93 | BHA-1612Z     | TC1350-136    |
| <b>HARD PARTS</b>                    |   |                                   |     |       |               |               |
| A95                                  | Housing, adapter                        | BW1350                            | 1   | 83-93 | E8TZ-7050-F   | TC1350-170-R  |
| A96                                  | Snap ring 41mm id                       | input bearing in housing          | 1   | 83-93 | E3TZ-7915-D   | TC1350-173-R  |
| A98                                  | Snap ring 71mm id                       | input bearing in housing          | 1   | 83-93 | E3TZ-7915-C   | TC1350-172-R  |
| A99                                  | Snap ring                               | sun gear to planetary             | 1   | 83-93 | E3RZ-7C122-A  | TC1350-175-R  |
| A100                                 | Gear, sun                               | BW1350                            | 1   | 83-93 | E3TZ-7D063-A  | TC1350-177-R  |
| A101                                 | Planetary assembly (4 pinion gears)     | BW1350                            | 1   | 83-91 | E6TZ-7A398-A  | TC1350-180-R  |
| A101                                 | Planetary assembly (6 pinion gears)     | BW1350                            | 1   | 92-93 | F1TZ-7A398-A  | TC1354-180-R  |
| A102                                 | Shaft, front input                      | BW1350                            | 1   | 83-91 | E3TZ-7017-D   | TC1350-182-R  |
| A102                                 | Shaft, front input                      | BW1350                            | 1   | 92-93 | F0TZ-7017-C   | TC1354-182-R  |
| A104                                 | Hub, range                              | BW1350                            | 1   | 83-91 | E3TZ-7100-E   | TC1350-183    |
| A104                                 | Hub, range                              | BW1350                            | 1   | 92-93 | F7TZ-7100-AA  | TC1350-183A   |
| A105                                 | Pin, pump drive                         | BW1350                            | 2   | 83-93 | E0TZ-7A250-A  | TC1350-184    |
| A106                                 | Shaft, rear output                      | BW1350                            | 1   | 83-90 | E3TZ-7061-H   | TC1350-186-R  |
| A106                                 | Shaft, rear output                      | BW1350                            | 1   | 91-93 | 1L5Z-7061-AA  | TC1350-186A-R |
| A107                                 | Spring, pump drive pin                  | BW1350                            | 1   | 83-93 | E0TZ-7A205-A  | TC1350-185    |
| A111                                 | Pump, oil assembly                      | BW1350                            | 1   | 83-93 | AE            | TC1356-200    |
| A113                                 | Retainer, oil pump                      | BW1350                            | 1   | 83-93 | E3TZ-7E215-C  | TC1350-187    |
| A115                                 | Clamp, oil pump hose                    | BW1350                            | 2   | 83-93 | 1345-056-005  | TC1356-204    |
| B126                                 | Sprocket, drive                         | BW1350                            | 1   | 83-93 | F2TZ-7177-A   | TC1350-190    |
| B127                                 | Collar, lock-up                         | BW1350                            | 1   | 83-93 | E3TZ-7106-B   | TC1350-192    |
| B128                                 | Spring, reduction                       | BW1350                            | 1   | 83-93 | F1TZ-7289-D   | TC1350-193-R  |
| B129                                 | Hub, reduction                          | BW1350                            | 1   | 83-93 | E3TZ-7D164-B  | TC1350-195    |
| B130                                 | Snap ring                               | BW1350                            | 1   | 83-93 | E3TZ-7917-E   | TC1350-196-R  |
| B131                                 | Hub, mode                               | BW1350                            | 1   | 83-93 | E3TZ-7100-D   | TC1350-197    |
| B133                                 | Snap ring                               | BW1350                            | 1   | 83-93 | E3TZ-7917-A   | TC1350-198-R  |
| B136                                 | Sleeve, speedo gear                     | BW1350                            | 1   | 83-93 | n/a           | TC1350-199    |
| B140                                 | Nut, rear output shaft                  | BW1350                            | 1   | 83-93 | n/a           | TC1350-201-R  |

BW1350





### Transfer Case Special Tools

ADV-0156PAC  
ADV-0156SMAC  
PTO Bench Mount



ADV-M109-R



NP236/242/262 seal installer

ADV-T-271

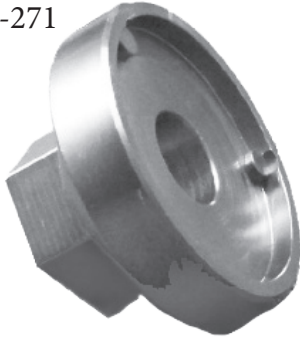

NP271 Linkage Nut Remover

T-246-198



NP246 Seal Installer

J-45358

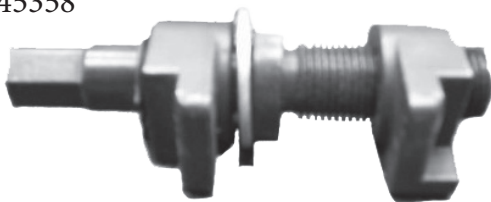

Case Spreader

J-29369-1



J-29369-2



Bearing Remover

RN-0156



PTO Bench Mount

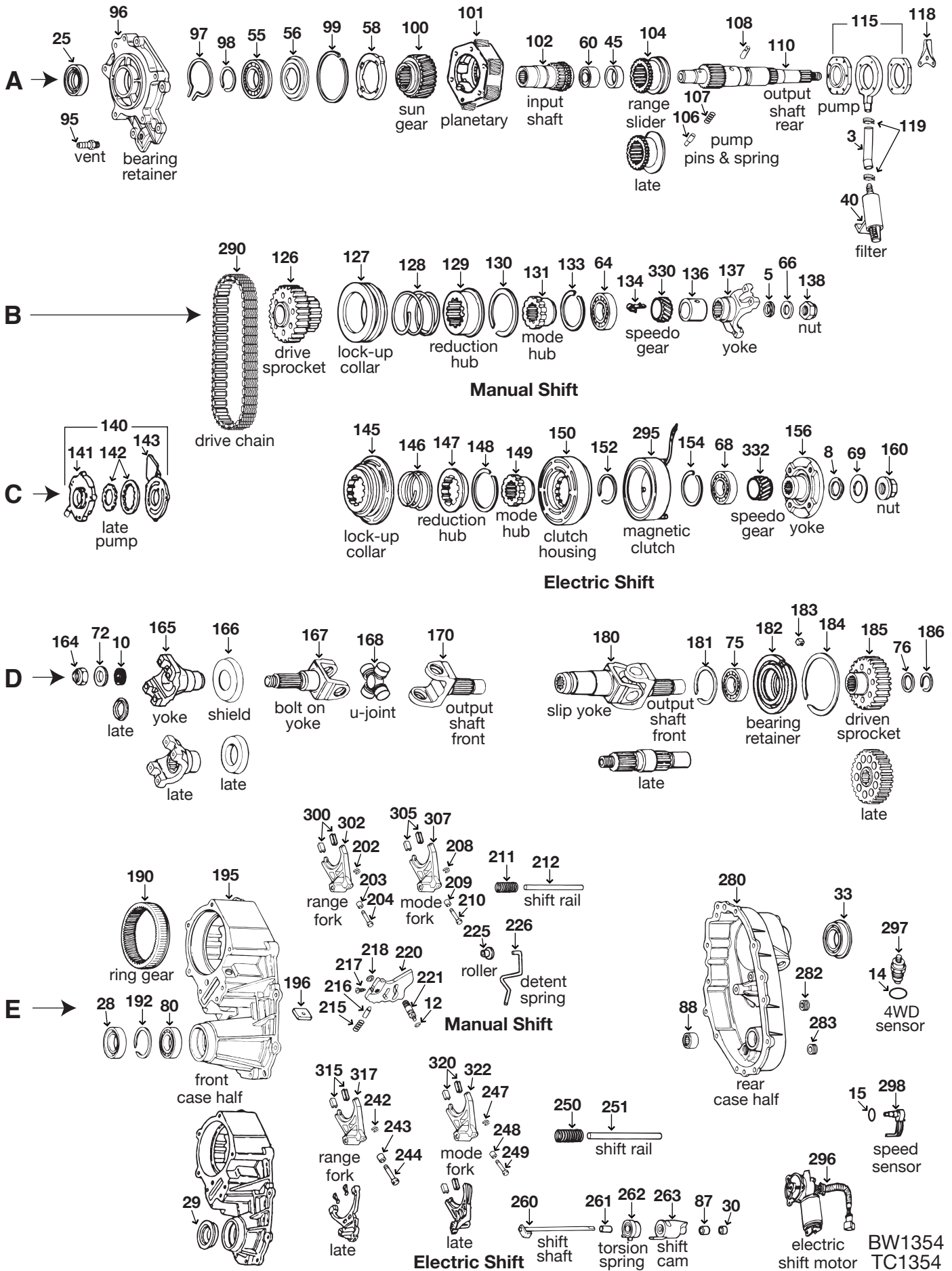

| ILL                                  | DESCRIPTION                             | QTY                              | YEAR | REFERENCE # | PART #        |               |
|--------------------------------------|---|----------------------------------|------|-------------|---------------|---------------|
| <b>REBUILDER KITS</b>                |   |                                  |      |             |               |               |
| K37                                  | Kit, bearing/gasket/seal                | BW1354                           | 1    | 91-04       | n/a           | TK-1354       |
| K37                                  | Kit, gasket/seal                        | BW1354                           | 1    | 91-04       | n/a           | K105-926      |
| <b>GASKETS AND RUBBER COMPONENTS</b> |   |                                  |      |             |               |               |
| A3                                   | Hose, oil pump                          | BW1354                           | 1    | 91-04       | E0TZ-7A098-AA | TC1356-203    |
| n/i                                  | Gasket, adapter                         | adapter housing to transfer case | 1    | 91-04       | M353317A      | 13594         |
| <b>METAL CLAD SEALS</b>              |   |                                  |      |             |               |               |
| A25                                  | Seal, metal clad                        | front output shaft               | 1    | 91-04       | F3TZ-7B215-A  | 205-16043     |
| E28                                  | Seal, metal clad                        | rear output shaft                | 1    | 91-04       | F3TZ-7B215-A  | 205-16043     |
| E33                                  | Seal, metal clad                        | front input shaft                | 1    | 91-04       | F3TZ-7B215-A  | 205-16043     |
| <b>FILTERS</b>                       |   |                                  |      |             |               |               |
| A40                                  | Filter, oil pump                        | BW1354                           | 1    | 91-04       | E0TZ-7A098-AA | TC1356-050    |
| <b>BUSHINGS</b>                      |   |                                  |      |             |               |               |
| A45                                  | Bushing                                 | front input shaft (rear)         | 1    | 91-04       | n/a           | TC1350-159    |
| <b>WASHERS/BEARINGS/RACES/SHIMS</b>  |   |                                  |      |             |               |               |
| A55                                  | Bearing, ball .628" 1.773" id 2.950" od | front input shaft                | 1    | 91-04       | E3TZ-7025-B   | 6009N         |
| A60                                  | Bearing, caged (cup)                    | front input shaft (middle)       | 1    | 91-04       | BCE-1816      | TC1350-135    |
| C68                                  | Bearing, ball .628" 1.180" id 2.435" od | front output shaft (rear)        | 1    | 91-04       | E3TZ-7025-A   | 6206N         |
| D75                                  | Bearing, ball .590" 1.573" id 2.675" od | front output shaft (front)       | 1    | 91-04       | E3TZ-7025-C   | 6008-J        |
| E80                                  | Bearing, ball .628" 1.180" id 2.435" od | front output shaft (middle)      | 1    | 91-04       | E3TZ-7025-A   | 6206N         |
| E88                                  | Bearing, caged (cup)                    | front output shaft (rear)        | 1    | 91-04       | BHA-1612Z     | TC1350-136    |
| <b>HARD PARTS</b>                    |   |                                  |      |             |               |               |
| A96                                  | Housing, adapter                        | BW1354                           | 1    | 91-04       | F0TZ-7050-B   | TC1354-170    |
| A97                                  | Snap ring 71mm id                       | BW1354                           | 1    | 91-04       | E3TZ-7915-C   | TC1350-172-R  |
| A98                                  | Snap ring 41mm id                       | BW1354                           | 1    | 91-04       | E3TZ-7915-D   | TC1350-173-R  |
| A99                                  | Snap ring                               | BW1354                           | 1    | 91-04       | E3RZ-7C122-A  | TC1350-175-R  |
| A100                                 | Gear, sun                               | BW1354                           | 1    | 91-04       | E3TZ-7D063-A  | TC1350-177-R  |
| A101                                 | Planetary assembly (6 pinion gears)     | BW1354                           | 1    | 91-04       | F1TZ-7A398-A  | TC1354-180-R  |
| A102                                 | Shaft, front input                      | BW1354                           | 1    | 91-04       | F0TZ-7017-C   | TC1354-182-R  |
| A104                                 | Hub, range                              | BW1354                           | 1    | 91-04       | F77Z-7100-AA  | TC1350-183A   |
| A106                                 | Pin, pump drive                         | BW1354                           | 2    | 91-04       | E0TZ-7A250-A  | TC1350-184    |
| A107                                 | Spring, pump drive pin                  | BW1354                           | 1    | 91-04       | E0TZ-7A205-A  | TC1350-185    |
| A110                                 | Shaft, rear output                      | BW1354                           | 1    | 91-04       | E3TZ-7061-H   | TC1350-186-R  |
| A110                                 | Shaft, rear output                      | BW1354                           | 1    | 91-04       | 1L5Z-7061-AA  | TC1350-186A-R |
| A115                                 | Pump, oil assembly                      | BW1354                           | 1    | 91-04       | AE            | TC1356-200    |
| A118                                 | Retainer, oil pump                      | BW1354                           | 1    | 91-04       | E3TZ-7E215-C  | TC1350-187    |
| A119                                 | Clamp, oil pump hose                    | BW1354                           | 2    | 91-04       | 1345-056-005  | TC1356-204    |
| B126                                 | Sprocket, drive                         | BW1354                           | 1    | 91-04       | F2TZ-7177-A   | TC1350-190    |
| B127                                 | Collar, lock-up                         | BW1354                           | 1    | 91-93       | F1TZ-7106-B   | TC1354-192    |
| B128                                 | Spring, reduction                       | BW1354                           | 1    | 91-04       | F1TZ-7289-D   | TC1350-193-R  |
| B129                                 | Hub, reduction                          | BW1354                           | 1    | 91-04       | E3TZ-7D164-B  | TC1350-195    |
| B130                                 | Snap ring                               | BW1354                           | 1    | 91-04       | E3TZ-7917-E   | TC1350-196-R  |
| B131                                 | Hub, mode                               | BW1354                           | 1    | 91-04       | E3TZ-7100-D   | TC1350-197    |
| B133                                 | Snap ring                               | BW1354                           | 1    | 91-04       | E3TZ-7917-A   | TC1350-198-R  |
| B136                                 | Sleeve, speedo gear                     | BW1354                           | 1    | 91-04       | n/a           | TC1350-199    |
| B138                                 | Nut, rear output shaft                  | BW1354                           | 1    | 91-04       | E3TZ-7045-C   | TC1350-201-R  |
| C145                                 | Collar, lock-up                         | with electric shift              | 1    | 91-93       | F1TZ-7106-B   | TC1354-192    |
| C146                                 | Spring, reduction                       | with electric shift              | 1    | 91-04       | E6TZ-7D126-A  | TC1354-193    |
| C147                                 | Hub, reduction                          | with electric shift              | 1    | 91-04       | E7TZ-7D164-A  | TC1354-202    |
| C148                                 | Snap ring                               | with electric shift              | 1    | 91-93       | E3TZ-7917-E   | TC1350-196-R  |
| C149                                 | Hub, mode                               | with electric shift              | 1    | 91-04       | E3TZ-7100-D   | TC1350-197    |
| C150                                 | Housing, clutch coil                    | with electric shift              | 1    | 91-04       | F1TZ-7G362-A  | TC1354-203    |
| C152                                 | Snap ring                               | with electric shift              | 1    | 91-04       | E3TZ-7917-A   | TC1350-198-R  |
| C154                                 | Snap ring                               | with electric shift              | 1    | 91-04       | E3TZ-7917-A   | TC1350-198-R  |

BW1354



### Transfer Case Special Fixes

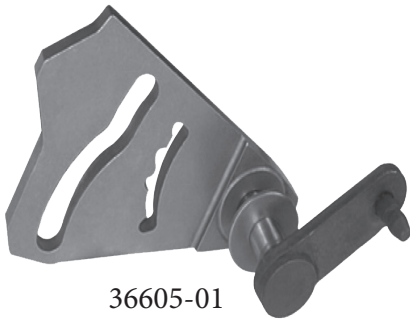

36605-01  
transfer case saver (bag of 5)  
BW1356



100240-01K  
split ring retainer  
foe NP230 series



100246-01  
anti-wear transfer case saver  
NP240/136

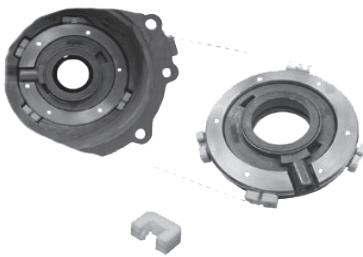

100246-02K  
transfer case pump plate  
for NP136/149/236/246/261/263



100420-02K  
split ring retainer  
foe NP240 series

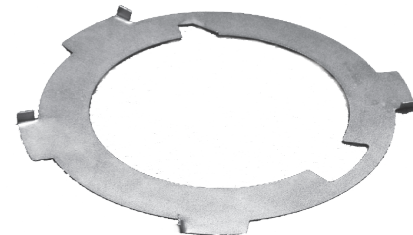

BRNY  
case repair plate  
foe NP136/23/246



TC-4405C  
casse repair insert  
for BW4405



K068  
rear output bearing retainer (bag of 3)  
for Np230 series



K067  
rear output bearing retainer (bag of 3)  
for Np240 series



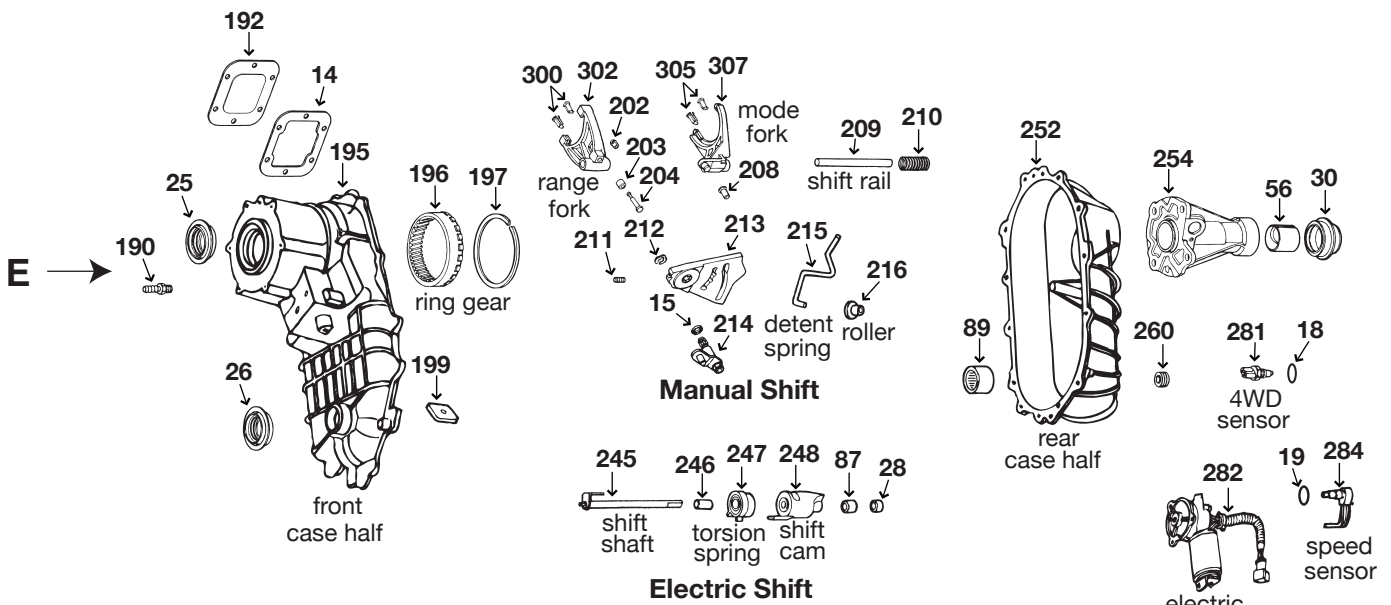
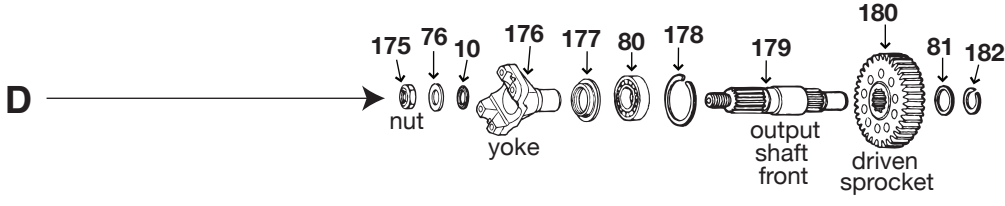
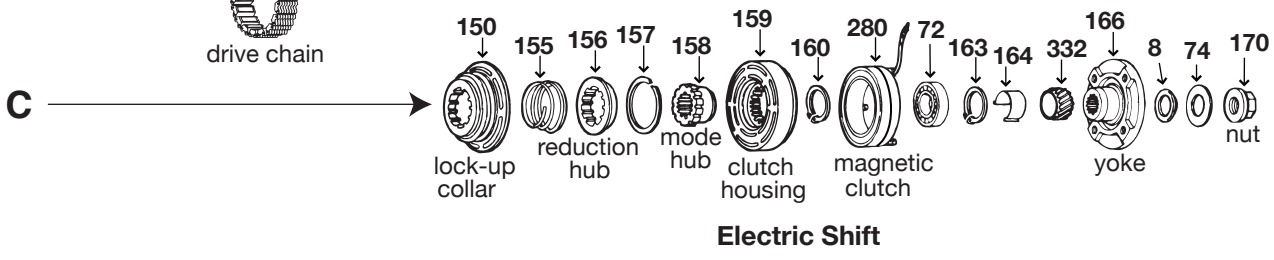
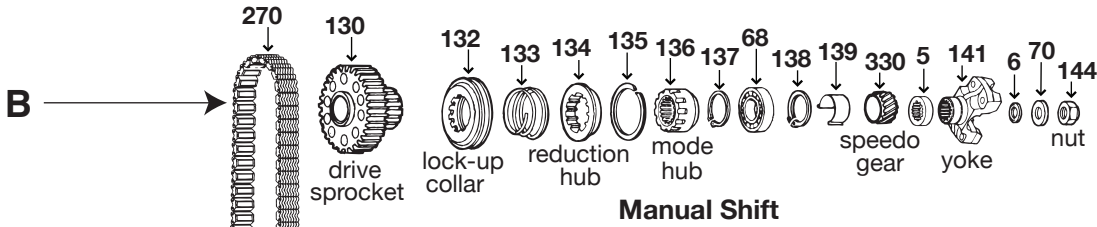
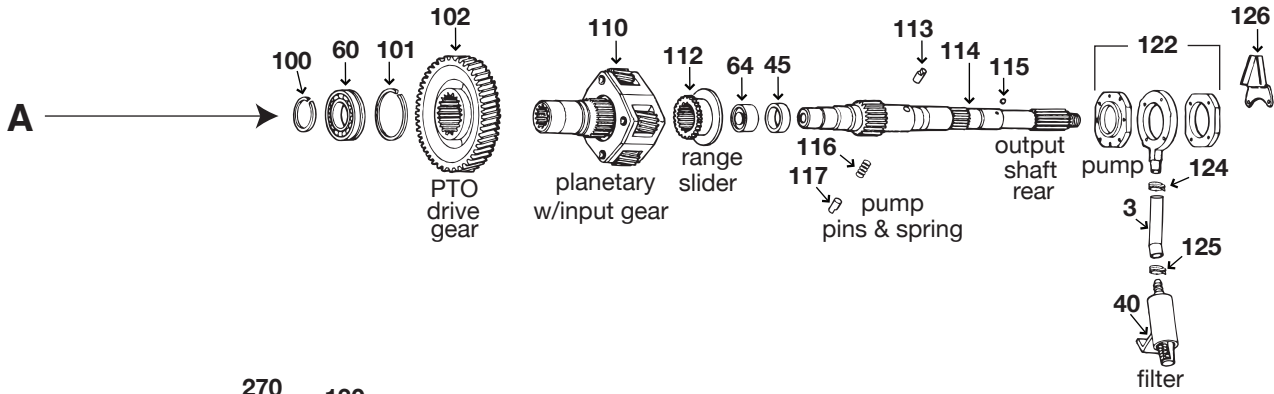

BW1356  
 TC1356

| ILL                                  | DESCRIPTION                             |                                    | QTY | YEAR  | REFERENCE #   | PART #     |
|--------------------------------------|---|------------------------------------|-----|-------|---------------|------------|
| <b>REBUILDER KITS</b>                |   |                                    |     |       |               |            |
| n/i                                  | Kit, bearing/gasket/seal                | BW1356                             | 1   | 87-97 | AE            | TK-1356    |
| n/i                                  | Kit, gasket/seal                        | BW1356                             | 1   | 87-97 | AE            | K105-931   |
| <b>GASKETS AND RUBBER COMPONENTS</b> |   |                                    |     |       |               |            |
| A3                                   | Hose, oil pump                          | BW1356                             | 1   | 87-97 | n/a           | TC1356-203 |
| n/i                                  | Gasket, adapter housing                 | BW1356                             | 1   | 87-97 | 04130678      | 13591      |
| <b>METAL CLAD SEALS</b>              |   |                                    |     |       |               |            |
| E25                                  | Seal, metal clad                        | front input                        | 1   | 87-97 | F4TZ-7B215-A  | 205-18994  |
| E26                                  | Seal, metal clad                        | front output                       | 1   | 87-97 | F4TZ-7B215-A  | 205-18994  |
| E26                                  | Seal, metal clad                        | front output                       | 1   | 94-97 | E5TZ-7B215-A  | 205-18892  |
| E30                                  | Seal, metal clad                        | rear output                        | 1   | 87-97 | F4TZ-7B215-B  | 205-18507  |
| E30                                  | Seal, metal clad                        | rear output (Bronco)               | 1   | 94-97 | F4TZ-7B215-A  | 205-18994  |
| <b>FILTERS</b>                       |   |                                    |     |       |               |            |
| A40                                  | Filter, oil pump                        | BW1356                             | 1   | 87-97 | E0TZ-7A098-AA | TC1356-050 |
| <b>BUSHINGS</b>                      |   |                                    |     |       |               |            |
| A45                                  | Bushing                                 | rear output shaft (front)          | 1   | 87-97 | n/a           | TC1356-165 |
| E56                                  | Bushing                                 | extension housing                  | 1   | 87-97 | TC1356-62     | TC1356-162 |
| <b>WASHERS/BEARINGS/RACES/SHIMS</b>  |   |                                    |     |       |               |            |
| A60                                  | Bearing, ball .628" 3.148" od 1.970" id | front input                        | 1   | 87-97 | E7TZ-7025-A   | 6010N      |
| A64                                  | Bearing, caged (open)                   | front input shaft                  | 1   | 87-97 | B-2012        | TC1356-135 |
| B68                                  | Bearing, ball .671" 1.377" id 2.837" od | rear output (rear)(manual shift)   | 1   | 87-97 | F0TZ-7025-B   | 6207N      |
| C72                                  | Bearing, ball .671" 1.377" id 2.837" od | rear output (rear)(electric shift) | 1   | 87-97 | F0TZ-7025-B   | 6207N      |
| D80                                  | Bearing, ball .671" 1.377" id 2.837" od | front output (front)               | 1   | 87-97 | C8TZ-7025-C   | 6207N      |
| E89                                  | Bearing, caged (cup)                    | front output shaft (rear)          | 1   | 87-97 | BK-3026       | TC1356-143 |
| <b>HARD PARTS</b>                    |   |                                    |     |       |               |            |
| A110                                 | Planetary kit                           | planet/ring gear/range hub         | 1   | 87-97 | F5TZ-7D323-BB | TC1356-250 |
| A112                                 | Hub, range shift (38T)                  | BW1356                             | 1   | 87-96 | E7TZ-7100-A   | TC1356-120 |
| A112                                 | Hub, range shift (31T)                  | BW1356                             | 1   | 97-97 | F5TZ-7100-C   | TC1356-121 |
| A114                                 | Shaft, rear output                      | w/slip yoke                        | 1   | 87-97 | E7TZ-7061-B   | TC1356-192 |
| A122                                 | Pump, oil assembly                      | BW1356                             | 1   | 87-97 | n/a           | TC1356-200 |
| A124                                 | Clamp, oil pump hose                    | BW1356                             | 1   | 87-97 | n/a           | TC1356-204 |
| A125                                 | Clamp, oil pump hose                    | BW1356                             | 1   | 87-97 | n/a           | TC1356-204 |
| A126                                 | Retainer, oil pump                      | BW1356                             | 1   | 87-97 | E7TZ-7E215-A  | TC1356-206 |
| B130                                 | Gear, drive sprocket                    | BW1356                             | 1   | 87-97 | E7TZ-7177-B   | TC1356-152 |
| D180                                 | Gear, driven sprocket                   | BW1356                             | 1   | 87-97 | 1356-144-002  | TC1356-185 |
| E245                                 | Shaft, shift                            | BW1356 electric shift              | 1   | 87-97 | 1356-122-007  | TC1356-209 |
| E247                                 | Spring, torsion                         | BW1356                             | 1   | 87-91 | n/a           | TC1356-207 |
| E248                                 | Cam, electric shift                     | BW1356                             | 1   | 91-97 | n/a           | TC1356-208 |
| E252                                 | Case, rear                              | manual shift                       | 1   | 87-97 | E7TZ-7005-C   | TC1356-101 |
| <b>TRANSFER CASE CHAINS</b>          |   |                                    |     |       |               |            |
| B270                                 | Chain, drive 84 links 1.250" wide (RP)  | BW1356                             | 1   | 87-97 | E2TZ-7A029-A  | HV-012     |
| <b>ELECTRICAL COMPONENTS</b>         |   |                                    |     |       |               |            |
| E282                                 | Motor, electric shift                   | round connector 7 pins             | 1   | 87-90 | E8TZ-7G360-B  | 600-804    |
| E282                                 | Motor, electric shift                   | round connector 7 pins             | 1   | 91-97 | F1TZ-7G360-C  | 600-801    |
| <b>SHIFT FORKS AND PADS</b>          |   |                                    |     |       |               |            |
| E300                                 | Pad, shift fork (nylon)                 | range                              | 2   | 87-97 | E9TZ-7C430-A  | TC1356-28  |
| E302                                 | Fork                                    | range                              | 1   | 87-97 | F1TZ-7289-A   | TC1356-123 |
| E305                                 | Pad (nylon)                             | mode                               | 3   | 87-97 | 1345-235-001  | TC1345-28  |
| E307                                 | Fork                                    | mode                               | 1   | 87-97 | 4400-596-002  | TC1356-124 |
| <b>SPEEDO GEARS</b>                  |   |                                    |     |       |               |            |
| C332                                 | Gear, speedo (yellow)                   | w/o steel sleeve                   | 1   | 87-97 | n/a           | 02-326     |
| <b>NOTES</b>                         |   |                                    |     |       |               |            |
|                                      |   |                                    |     |       |               |            |

BW1356

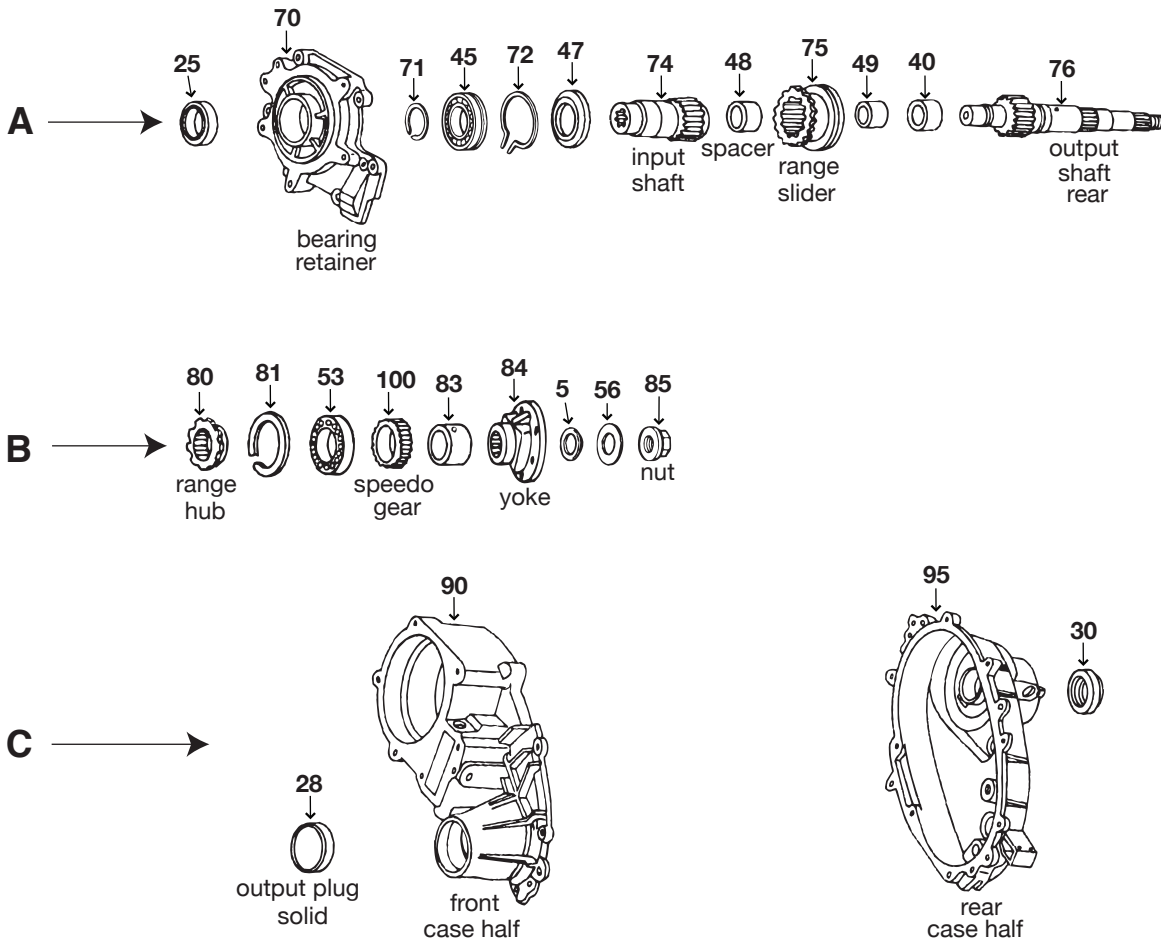

BW1359  
TC1359

| ILL                                  | DESCRIPTION                             | QTY | YEAR  | REFERENCE #  | PART #           |
|--------------------------------------|---|-----|-------|--------------|------------------|
| <b>REBUILDER KITS</b>                |   |     |       |              |                  |
| n/i                                  | Kit, bearing/gasket/seal                | 1   | 84-90 | TCRK-1359    | <b>TK-1359</b>   |
| n/i                                  | Kit, gasket/seal                        | 1   | 84-90 | DTK-1359     | <b>K105-947</b>  |
| <b>GASKETS AND RUBBER COMPONENTS</b> |   |     |       |              |                  |
| n/i                                  | Gasket, adapter                         | 1   | 87-89 | M353317A     | <b>13594</b>     |
| <b>METAL CLAD SEALS</b>              |   |     |       |              |                  |
| A25                                  | Seal, metal clad                        | 1   | 87-89 | E3TZ-7B215-F | <b>205-17502</b> |
| C30                                  | Seal, metal clad                        | 1   | 87-89 | F3TZ-7B215-A | <b>205-16043</b> |
| <b>WASHERS/BEARINGS/RACES/SHIMS</b>  |   |     |       |              |                  |
| A45                                  | Bearing, ball .628" 1.773" id 2.950" od | 1   | 84-90 | E7TZ-7025-B  | <b>6009N</b>     |
| B53                                  | Bearing, ball .628" 1.180" id 2.435" od | 1   | 84-90 | E7TZ-7025-C  | <b>6206N</b>     |

**NOTES**

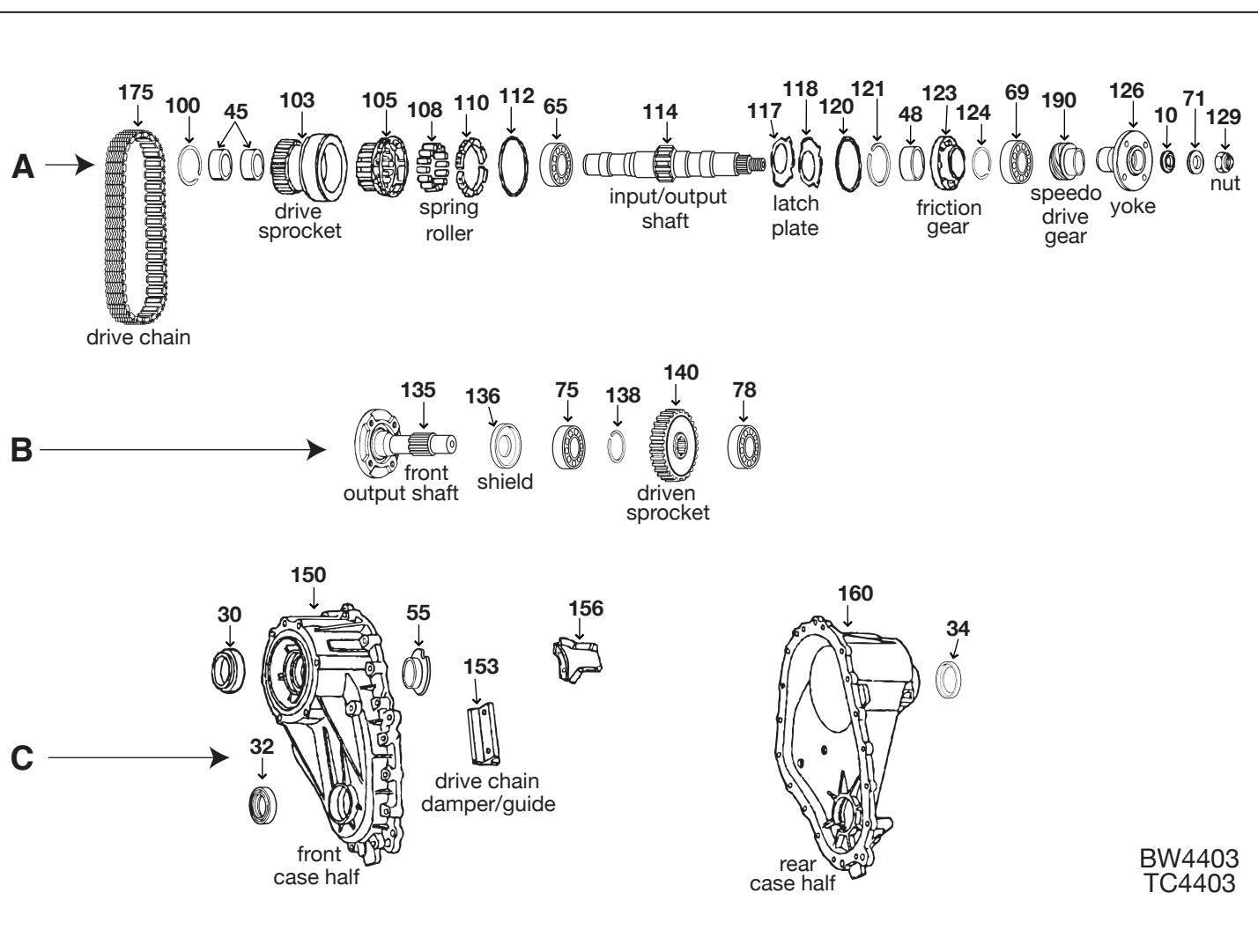

BW4403  
TC4403

| ILL                                  | DESCRIPTION                             | QTY | YEAR  | REFERENCE #   | PART #           |
|--------------------------------------|---|-----|-------|---------------|------------------|
| <b>REBUILDER KITS</b>                |   |     |       |               |                  |
| n/i                                  | Kit, bearing/gasket/seal                | 1   | 99-01 | AE            | <b>TK-4403</b>   |
| n/i                                  | Kit, gasket/seal                        | 1   | 99-01 | AE            | <b>K105-944</b>  |
| <b>GASKETS AND RUBBER COMPONENTS</b> |   |     |       |               |                  |
| n/i                                  | Gasket, adapter                         | 1   | 99-01 | M353317A      | <b>13594</b>     |
| <b>METAL CLAD SEALS</b>              |   |     |       |               |                  |
| C30                                  | Seal, metal clad                        | 1   | 99-01 | XL2Z-7B215-AA | <b>205-18662</b> |
| C32                                  | Seal, metal clad                        | 1   | 99-01 | F3TZ-7B215-A  | <b>205-16043</b> |
| C34                                  | Seal, metal clad                        | 1   | 99-01 | F3TZ-7B215-A  | <b>205-16043</b> |
| <b>WASHERS/BEARINGS/RACES/SHIMS</b>  |   |     |       |               |                  |
| A65                                  | Bearing, ball .628" 1.773" id 2.950" od | 1   | 99-01 | XL2Z-7025-AA  | <b>6009N</b>     |
| A69                                  | Bearing, ball .628" 1.180" id 2.435" od | 1   | 99-01 | E3TZ-7025-A   | <b>6206N</b>     |
| B75                                  | Bearing, ball .628" 1.180" id 2.435" od | 1   | 99-01 | E3TZ-7025-A   | <b>6206N</b>     |
| B78                                  | Bearing, ball .628" 1.773" id 2.950" od | 1   | 99-01 | XL2Z-7025-AA  | <b>6009N</b>     |
| <b>TRANSFER CASE CHAINS</b>          |   |     |       |               |                  |
| A175                                 | Chain, drive 74 links 1.250" wide (RJ)  | 1   | 99-01 | XL2Z-7A029-AA | <b>HV-051</b>    |
| <b>NOTES</b>                         |   |     |       |               |                  |
|                                      |   |     |       |               |                  |
|                                      |   |     |       |               |                  |
|                                      |   |     |       |               |                  |
|                                      |   |     |       |               |                  |
|                                      |   |     |       |               |                  |

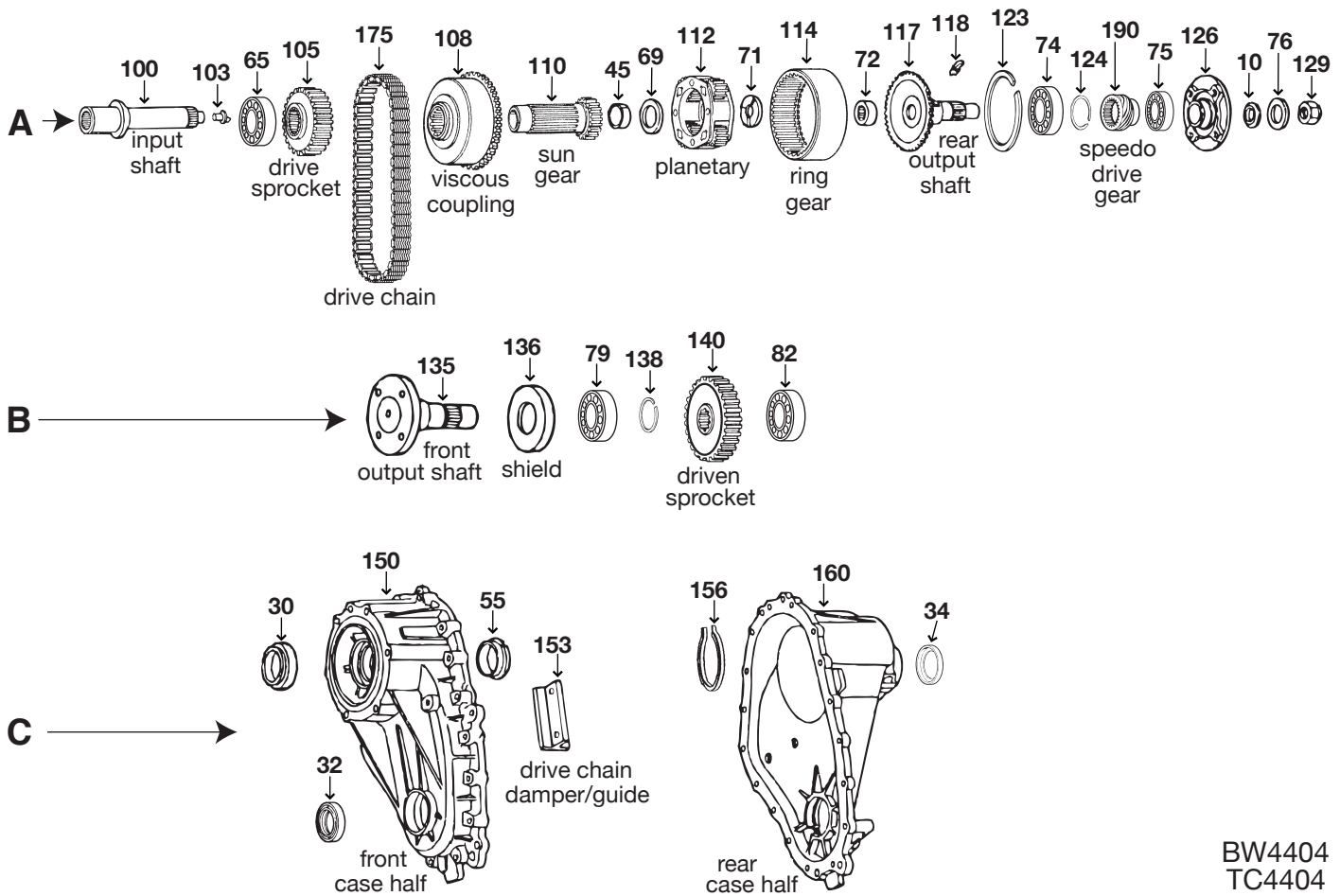

BW4404  
TC4404

| ILL                                  | DESCRIPTION                             | QTY | YEAR  | REFERENCE #   | PART #              |
|--------------------------------------|---|-----|-------|---------------|---------------------|
| <b>REBUILDER KITS</b>                |   |     |       |               |                     |
| n/i                                  | Kit, bearing/gasket/seal                | 1   | 96-03 | AE            | <b>TK-4404</b>      |
| n/i                                  | Kit, gasket/seal                        | 1   | 96-03 | AE            | <b>K105-929</b>     |
| <b>GASKETS AND RUBBER COMPONENTS</b> |   |     |       |               |                     |
| n/i                                  | Gasket, adapter housing                 | 1   | 96-03 | 04130678      | <b>13591</b>        |
| <b>METAL CLAD SEALS</b>              |   |     |       |               |                     |
| C30                                  | Seal, metal clad                        | 1   | 96-03 | F4TZ-7B215-A  | <b>205-18771</b>    |
| C32                                  | Seal, metal clad                        | 1   | 96-03 | F3TZ-7B215-A  | <b>205-16043</b>    |
| C34                                  | Seal, metal clad                        | 1   | 96-03 | F3TZ-7B215-A  | <b>205-16043</b>    |
| <b>BUSHINGS</b>                      |   |     |       |               |                     |
| C55                                  | Bushing                                 | 1   | 96-03 | F67Z-7Z227-AA | <b>TC4404-165</b>   |
| <b>WASHERS/BEARINGS/RACES/SHIMS</b>  |   |     |       |               |                     |
| A65                                  | Bearing, ball .628" 1.773" id 2.950" od | 1   | 96-03 | XL2Z-7025-AA  | <b>6009N</b>        |
| A72                                  | Bearing, cage .624" .823" id 1.132" od  | 1   | 96-03 | SCH1310       | <b>JH1310</b>       |
| A74                                  | Bearing, ball .708" 1.565" id 3.148" od | 1   | 96-03 | F5TZ-7025-C   | <b>6208N</b>        |
| A75                                  | Bearing, ball .352" 1.174" id 2.166" od | 1   | 96-03 | 16006         | <b>16006</b>        |
| A75                                  | Bearing, ball .510" 1.174" id 2.166" od | 1   | 96-03 | 6006          | <b>6006</b>         |
| B79                                  | Bearing, ball .671" 1.377" id 2.837" od | 1   | 96-03 | C8TZ-7025-C   | <b>6207N</b>        |
| B82                                  | Bearing, ball .628" 1.180" id 2.435" od | 1   | 96-03 | E7TZ-7025-C   | <b>6206N</b>        |
| <b>HARD PARTS</b>                    |   |     |       |               |                     |
| A100                                 | Gear, input shaft                       | 1   | 96-03 | F67Z-7017-AA  | <b>TC4404-150</b>   |
| A105                                 | Gear, drive sprocket                    | 1   | 96-03 | 4404-144-001  | <b>TC4404-175-R</b> |
| A108                                 | Clutch, viscous assembly                | 1   | 96-03 | 4404-625-001  | <b>TC4404-178</b>   |
| A110                                 | Gear, planetary sun                     | 1   | 96-03 | 4404-665-001  | <b>TC4404-180-R</b> |
| A112                                 | Gear, planetary                         | 1   | 96-03 | 4472-659-003  | <b>TC4404-182-R</b> |





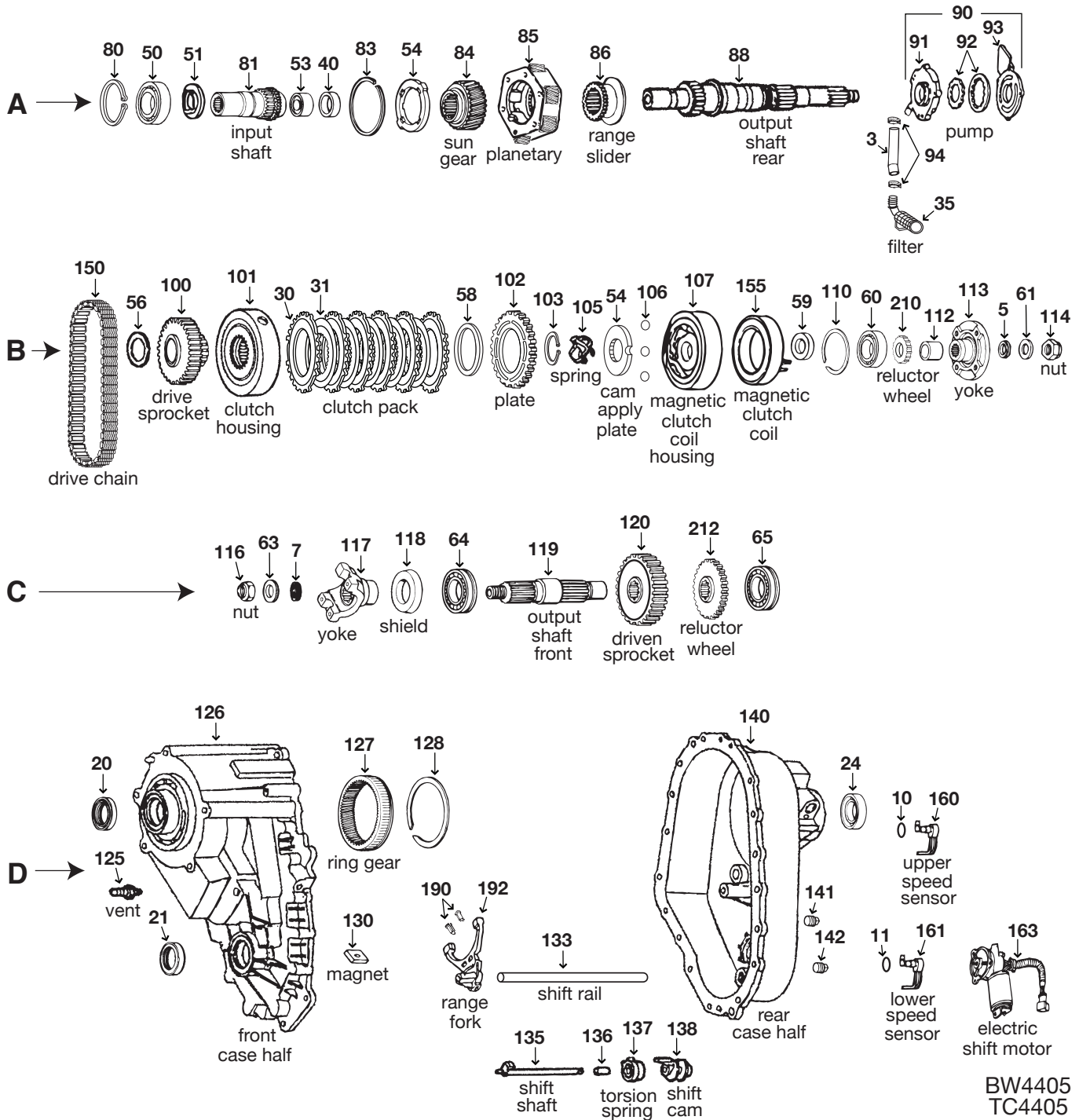

BW4405  
TC4405

| ILL                                  | DESCRIPTION                  | QTY | YEAR  | REFERENCE #  | PART #            |
|--------------------------------------|------------------------------|-----|-------|--------------|-------------------|
| <b>REBUILDER KITS</b>                |                              |     |       |              |                   |
| n/i                                  | Kit, bearing/gasket/seal     | 1   | 95-01 | AE           | <b>TK-4405</b>    |
| n/i                                  | Kit, gasket/seal             | 1   | 95-01 | AE           | <b>K105-938</b>   |
| <b>GASKETS AND RUBBER COMPONENTS</b> |                              |     |       |              |                   |
| n/i                                  | Gasket, adapter              | 1   | 95-06 | M353317A     | <b>13594</b>      |
| <b>METAL CLAD SEALS</b>              |                              |     |       |              |                   |
| D20                                  | Seal, metal clad             | 1   | 95-01 | F3TZ-7B215-A | <b>205-16043</b>  |
| D21                                  | Seal, metal clad             | 1   | 95-01 | F3TZ-7B215-A | <b>205-16043</b>  |
| D24                                  | Seal, metal clad             | 1   | 95-01 | F3TZ-7B215-A | <b>205-16043</b>  |
| <b>CLUTCH PLATES</b>                 |                              |     |       |              |                   |
| B30                                  | Friction .078" 4.727" id 31T | 6   | 95-01 | 138731-195   | <b>TC4405-103</b> |
| B31                                  | Friction .078" 5.590" od 19T | 5   | 95-01 | 138730-195   | <b>TC4405-104</b> |

| ILL                                 | DESCRIPTION                             |                                      | QTY | YEAR  | REFERENCE #   | PART #         |
|-------------------------------------|---|--------------------------------------|-----|-------|---------------|----------------|
| <b>FILTERS</b>                      |   |                                      |     |       |               |                |
| A35                                 | Filter                                  | BW4405                               | 1   | 95-01 | 4400-238-002  | TC4405-050     |
| <b>BUSHINGS</b>                     |   |                                      |     |       |               |                |
| A40                                 | Bushing                                 | input shaft (inner)                  | 1   | 95-01 | 1345-127-002  | TC4405-165     |
| <b>WASHERS/BEARINGS/RACES/SHIMS</b> |   |                                      |     |       |               |                |
| A50                                 | Bearing, ball .747" 3.344" od 1.772" id | front input shaft                    | 1   | 95-01 | F57Z-7127-A   | 6209N          |
| A53                                 | Bearing, caged (cup)                    | front input shaft (inner)            | 1   | 95-01 | BCE-1816      | TC1350-135     |
| B60                                 | Bearing, ball .746" 2.832" od 1.180" id | output shaft (rear)                  | 1   | 95-01 | F0TZ-7025-B   | 6306N          |
| C64                                 | Bearing, ball .746" 2.832" od 1.180" id | front output shaft (front)           | 1   | 95-01 | F0TZ-7025-B   | 6306N          |
| C65                                 | Bearing, ball .628" 1.180" id 2.435" od | front output shaft (rear)            | 1   | 95-01 | F57Z-7025-A   | 6206N          |
| <b>HARD PARTS</b>                   |   |                                      |     |       |               |                |
| A81                                 | Gear, input shaft                       | BW4405                               | 1   | 95-01 | F57Z-7017-A   | TC4405-150     |
| A84                                 | Gear, sun                               | BW4405                               | 1   | 95-01 | E3TZ-7D063-A  | TC1350-177-R   |
| A85                                 | Planetary assembly (6 pinion gears)     | BW4405                               | 1   | 95-01 | F1TZ-7A398-A  | TC1354-180-R   |
| A86                                 | Hub, range                              | BW4405                               | 1   | 95-01 | F7TZ-7100-AA  | TC1350-183A    |
| A88                                 | Shaft, rear output                      | BW4405                               | 1   | 95-01 | AE            | TC4405-190-R   |
| A90                                 | Pump assembly                           | BW4405                               | 1   | 95-01 | AE            | TC4405-200-R   |
| B100                                | Gear, drive sprocket                    | BW4405 (1.250" wide chain)           | 1   | 95-97 | 4405-644-001  | TC4405-195     |
| B100                                | Gear, drive sprocket                    | BW4405 (1" wide chain)               | 1   | 97-01 | 4405-644-002  | TC4405-196     |
| B107                                | Housing, magnetic clutch                | BW4405                               | 1   | 95-01 | 4405-212-902  | TC4405-175-R   |
| C119                                | Shaft, front output                     | BW4405                               | 1   | 95-01 | AE            | TC4405-215-R   |
| C120                                | Gear, driven sprocket                   | BW4405 (1.250" wide chain)           | 1   | 95-97 | 4405-144-006  | TC4405-220     |
| C120                                | Gear, driven sprocket                   | BW4405 (1" wide chain)               | 1   | 97-01 | 4405-144-008  | TC4405-221     |
| D126                                | Housing, front case                     | BW4405                               | 1   | 95-01 | AE            | TC4405-223-R   |
| D135                                | Shaft, shift                            | BW4405                               | 1   | 95-01 | 1350-053-002  | TC1354-206     |
| D137                                | Spring, shift cam                       | BW4405                               | 1   | 95-01 | 1350-165-008  | TC1354-208     |
| D138                                | Cam, shift                              | BW4405                               | 1   | 95-01 | 4405-099-009  | TC4405-099     |
| D140                                | Housing, rear case                      | BW4405 (manual shift)                | 1   | 95-01 | 4405-539-004  | TC4405-225     |
| D140                                | Housing, rear case                      | BW4405 (electric shift)              | 1   | 95-01 | 4405-539-007  | TC4405-226     |
| n/i                                 | Guide, roller (shift fork repair)       | BW4405 (Sonnax)                      | 1   | 95-01 | 100329-01K    | SON-100329-01K |
| n/i                                 | Tab, pump stop repair                   | BW4405 (Sonnax)                      | 1   | 95-01 | 100912-01K    | SON-100912-01K |
| n/i                                 | Tab, pump stop repair                   | BW4405 (Adapt-a-case)                | 1   | 95-01 | TC4405C       | ADV-TC4405C    |
| <b>TRANSFER CASE CHAINS</b>         |   |                                      |     |       |               |                |
| B150                                | Chain, drive 74 links 1.250" wide (RJ)  | BW4405                               | 1   | 95-97 | XL2Z-7A029-AA | HV-051         |
| B150                                | Chain, drive 74 links 1" wide (RJ)      | BW4405                               | 1   | 97-01 | XL2Z-7A029-BB | HV-067         |
| <b>ELECTRICAL COMPONENTS</b>        |   |                                      |     |       |               |                |
| B155                                | Coil, magnetic clutch                   | BW4411                               | 1   | 95-01 | 4400-015-020  | TC4405-180     |
| D163                                | Motor, electric shaft                   | BW4405 (7-pin rectangular connector) | 1   | 95-01 | XL2Z-7G360-AA | 600-803        |
| <b>SHIFT FORKS AND PADS</b>         |   |                                      |     |       |               |                |
| D190                                | Pad, shift fork (nylon)                 | range                                | 2   | 95-06 | E9TZ-7C430-A  | TC1356-28      |
| D192                                | Fork, range                             | casting #4405-096-903                | 1   | 95-06 | F57Z-7289-A   | TC4405-123     |
| <b>NOTES</b>                        |   |                                      |     |       |               |                |
|                                     |   |                                      |     |       |               |                |
|                                     |   |                                      |     |       |               |                |
|                                     |   |                                      |     |       |               |                |
|                                     |   |                                      |     |       |               |                |
|                                     |   |                                      |     |       |               |                |
|                                     |   |                                      |     |       |               |                |
|                                     |   |                                      |     |       |               |                |
|                                     |   |                                      |     |       |               |                |
|                                     |   |                                      |     |       |               |                |
|                                     |   |                                      |     |       |               |                |
|                                     |   |                                      |     |       |               |                |
|                                     |   |                                      |     |       |               |                |

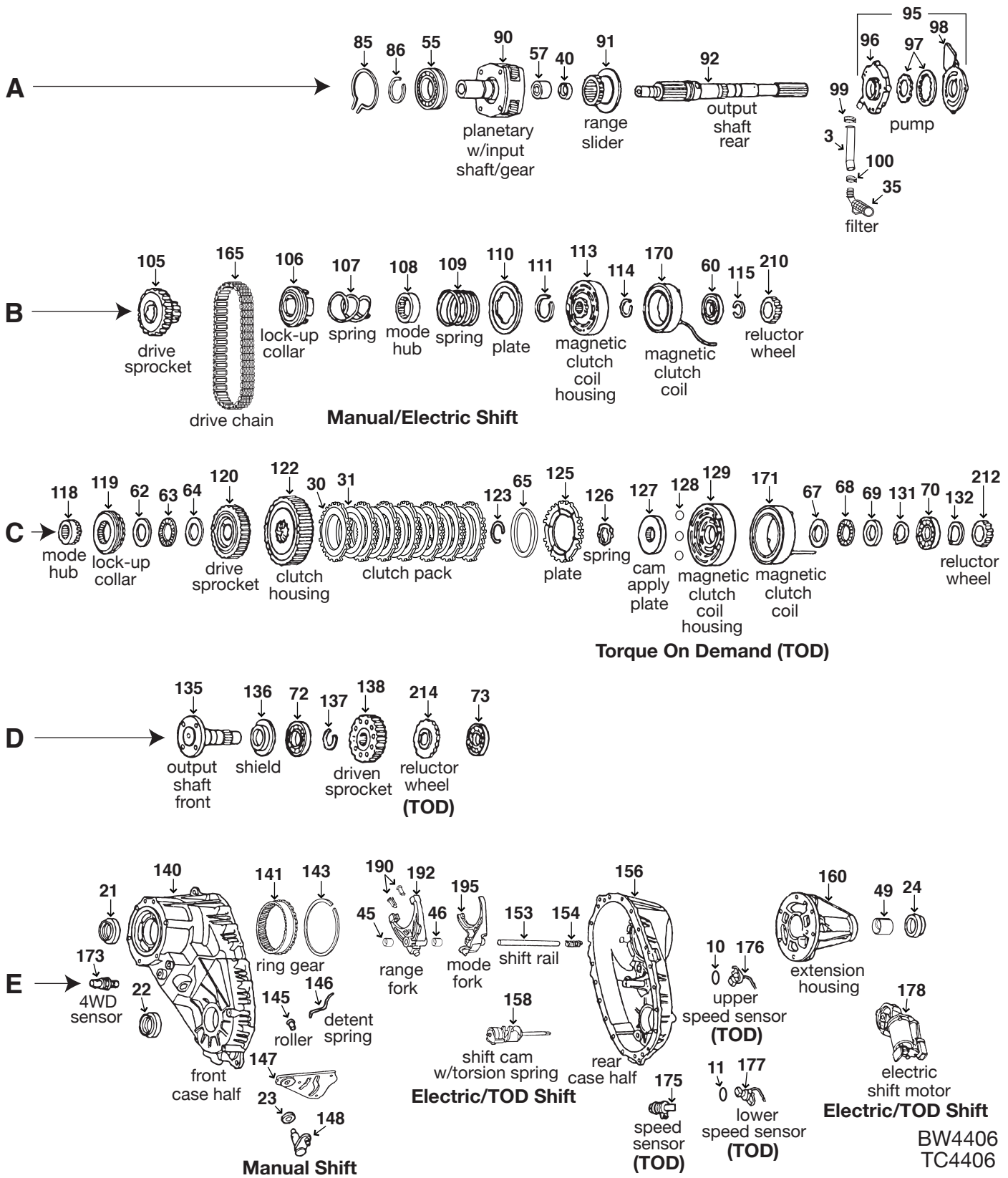

BW4406  
TC4406

| ILL                                  | DESCRIPTION              | QTY | YEAR  | REFERENCE # | PART #          |
|--------------------------------------|--------------------------|-----|-------|-------------|-----------------|
| <b>REBUILDER KITS</b>                |                          |     |       |             |                 |
| n/i                                  | Kit, bearing/gasket/seal | 1   | 97-04 | AE          | <b>TK-4406</b>  |
| n/i                                  | Kit, gasket/seal         | 1   | 97-04 | AE          | <b>K105-923</b> |
| <b>GASKETS AND RUBBER COMPONENTS</b> |                          |     |       |             |                 |
| n/i                                  | Gasket, adapter housing  | 1   | 97-04 | 04130678    | <b>13591</b>    |

| ILL                                 | DESCRIPTION                             |  | QTY | YEAR  | REFERENCE #   | PART #       |
|-------------------------------------|---|--|-----|-------|---------------|--------------|
| <b>METAL CLAD SEALS</b>             |   |  |     |       |               |              |
| E21                                 | Seal, metal clad                        | input shaft  | 1   | 97-04 | F77Z-7B215-AA | 205-18771    |
| E22                                 | Seal, metal clad                        | front output shaft                                   | 1   | 97-04 | F4TZ-7B215-A  | 205-18994    |
| E24                                 | Seal, metal clad                        | rear output shaft                                    | 1   | 97-04 | F4TZ-7B215-B  | 205-18507    |
| <b>CLUTCH PLATES</b>                |   |  |     |       |               |              |
| C30                                 | Friction .065" 4.727" id 31T            | external teeth (TOD)                                 | 7   | 97-04 | APC-138731    | TC4406-103   |
| C31                                 | Friction .065" 5.590" id 19T            | internal teeth (TOD)                                 | 6   | 97-04 | APC-138730    | TC4406-104   |
| <b>FILTERS</b>                      |   |  |     |       |               |              |
| A35                                 | Filter, oil                             | BW4406   | 1   | 97-04 | 4400-238-003  | TC4406-050   |
| <b>BUSHINGS</b>                     |   |  |     |       |               |              |
| A40                                 | Bushing                                 | input shaft (inner)                                  | 1   | 97-04 | n/a           | TC4406-165   |
| E49                                 | Bushing                                 | extension housing                                    | 1   | 97-04 | TC1356-62     | TC1356-162   |
| <b>WASHERS/BEARINGS/RACES/SHIMS</b> |   |  |     |       |               |              |
| A55                                 | Bearing, ball .830" 3.935" od 2.165" id | front input shaft                                    | 1   | 97-04 | F5TZ-7025-B   | 6211L        |
| A57                                 | Bearing, caged (cup)                    | front input shaft (inner)                            | 1   | 97-04 | BK-3026       | TC4406-135   |
| B60                                 | Bearing, ball .671" 1.377" id 2.837" od | rear output shaft (manual/electric shift)            | 1   | 97-04 | F0TZ-7005-A   | 6207N        |
| C70                                 | Bearing, ball .671" 1.377" id 2.837" od | rear output shaft (TOD)                              | 1   | 97-04 | F0TZ-7005-A   | 6207N        |
| D72                                 | Bearing, ball .708" 1.565" id 3.148" od | front output shaft (front)                           | 1   | 97-04 | F5TZ-7025-C   | 6208N        |
| D73                                 | Bearing, ball .671" 1.377" id 2.837" od | front output shaft (rear)                            | 1   | 97-04 | F0TZ-7005-A   | 6207N        |
| <b>HARD PARTS</b>                   |   |  |     |       |               |              |
| A90                                 | Gear, planetary w/input                 | BW4406 (manual/electric shift)                       | 1   | 97-04 | 4406-659-003  | TC4406-175-R |
| A90                                 | Gear, planetary w/input                 | BW4406 (w/torque on demand)                          | 1   | 97-04 | 4406-659-002  | TC4406-176-R |
| A91                                 | Hub, range slider                       | BW4406   | 1   | 97-04 | 4407-089-003  | TC4406-179-R |
| A92                                 | Shaft, rear output                      | BW4406   | 1   | 97-04 | AE            | TC4406-190-R |
| A95                                 | Pump, oil assembly                      | BW4406   | 1   | 97-04 | AE            | TC4406-200-R |
| B105                                | Gear, drive sprocket                    | BW4406 (with 1.250" chain)                           | 1   | 97-98 | 4406-144-002  | TC4406-195-R |
| B105                                | Gear, drive sprocket                    | BW4406 (with 1" chain)                               | 1   | 98-04 | 4406-625-005  | TC4406-196-R |
| C120                                | Gear, drive sprocket                    | BW4406 (w/torque on demand)                          | 1   | 97-04 | 4406-144-001  | TC4406-197-R |
| D138                                | Gear, driven sprocket                   | BW4406 (with 1" chain)                               | 1   | 98-04 | AE            | TC4406-206-R |
| D138                                | Gear, driven sprocket                   | BW4406 (with 1.250" chain)                           | 1   | 97-04 | AE            | TC4406-205-R |
| E140                                | Housing, front case                     | BW4406   | 1   | 97-04 | AE            | TC4406-210-R |
| E158                                | Shaft, shift w/spring/cam               | BW4406   | 1   | 97-04 | AE            | TC4406-215-R |
| E156                                | Housing, rear case                      | BW4406   | 1   | 97-04 | AE            | TC4406-220-R |
| E160                                | Housing, extension                      | BW4406 casting # 4406-066-901w/speedo & sensor holes | 1   | 97-04 | 4406-566-004  | TC4406-275   |
| <b>TRANSFER CASE CHAINS</b>         |   |  |     |       |               |              |
| B165                                | Chain, drive 86 links 1.250" wide (RP)  | BW4406   | 1   | 97-98 | F65Z-7A029-AA | HV-052       |
| B165                                | Chain, drive 86 links 1.250" wide (RJ)  | BW4406 (with TOD)                                    | 1   | 97-04 | XL1Z-7A029-AA | HV-053       |
| B165                                | Chain, drive 86 links 1" wide (RP)      | BW4406   | 1   | 98-04 | XL3Z-7A029-AA | HV-066       |
| <b>ELECTRICAL COMPONENTS</b>        |   |  |     |       |               |              |
| E178                                | Motor, electric shift                   | BW4406 (7-pin rectangular connector)                 | 1   | 97-04 | YL2Z-7G360-AB | 600-802      |
| <b>SHIFT FORKS AND PADS</b>         |   |  |     |       |               |              |
| E190                                | Pad, shift fork (nylon)                 | range  | 2   | 97-04 | E9TZ-7C430-A  | TC1356-28    |
| E192                                | Fork, aluminum                          | range  | 1   | 97-04 | 4406-596-005  | TC4406-123   |
| E195                                | Fork                                    | mode (w/torque on demand)                            | 1   | 97-04 | 4406-096-002  | TC4406-124   |
| E195                                | Fork                                    | mode (w/o torque on demand)                          | 1   | 97-04 | 4406-096-007  | TC4406-125   |
| <b>NOTES</b>                        |   |  |     |       |               |              |
|                                     |   |  |     |       |               |              |
|                                     |   |  |     |       |               |              |
|                                     |   |  |     |       |               |              |
|                                     |   |  |     |       |               |              |
|                                     |   |  |     |       |               |              |
|                                     |   |  |     |       |               |              |
|                                     |   |  |     |       |               |              |
|                                     |   |  |     |       |               |              |
|                                     |   |  |     |       |               |              |
|                                     |   |  |     |       |               |              |

BW4406



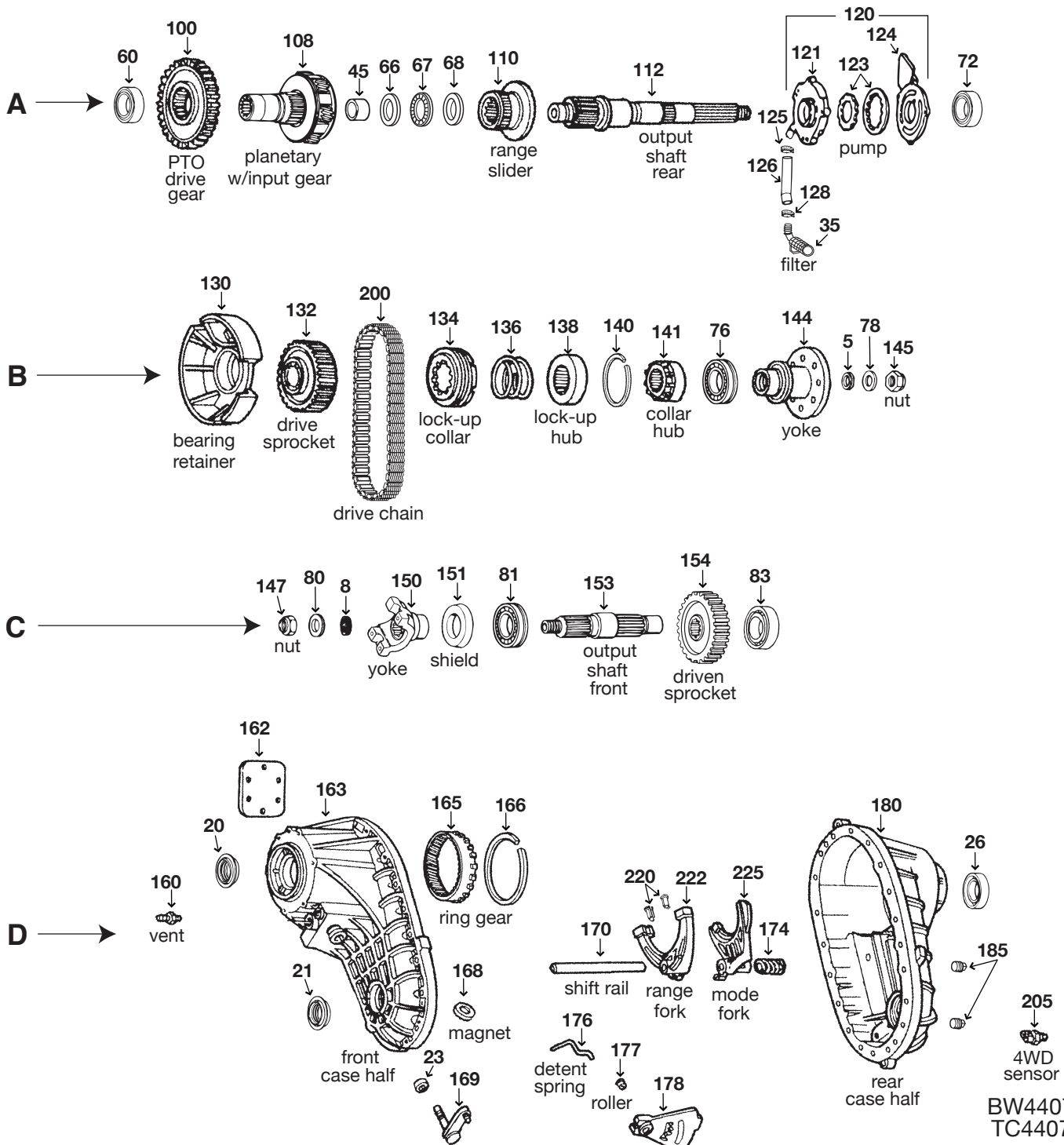

BW4407  
TC4407

| ILL                                  | DESCRIPTION              | QTY | YEAR  | REFERENCE #  | PART #           |
|--------------------------------------|--------------------------|-----|-------|--------------|------------------|
| <b>REBUILDER KITS</b>                |                          |     |       |              |                  |
| n/i                                  | Kit, bearing/gasket/seal | 1   | 96-97 | AE           | <b>TK-4407</b>   |
| n/i                                  | Kit, gasket/seal         | 1   | 96-97 | AE           | <b>K105-943</b>  |
| <b>GASKETS AND RUBBER COMPONENTS</b> |                          |     |       |              |                  |
| n/i                                  | Gasket, adapter housing  | 1   | 96-97 | 04130678     | <b>13591</b>     |
| <b>METAL CLAD SEALS</b>              |                          |     |       |              |                  |
| D20                                  | Seal, metal clad         | 1   | 96-97 | F4TZ-7B215-A | <b>205-18994</b> |
| D21                                  | Seal, metal clad         | 1   | 96-97 | F4TZ-7B215-A | <b>205-18994</b> |
| D26                                  | Seal, metal clad         | 1   | 96-97 | F4TZ-7B215-A | <b>205-18994</b> |
| D23                                  | Seal, metal clad         | 1   | 96-97 | 1900-044-011 | <b>205-3687</b>  |



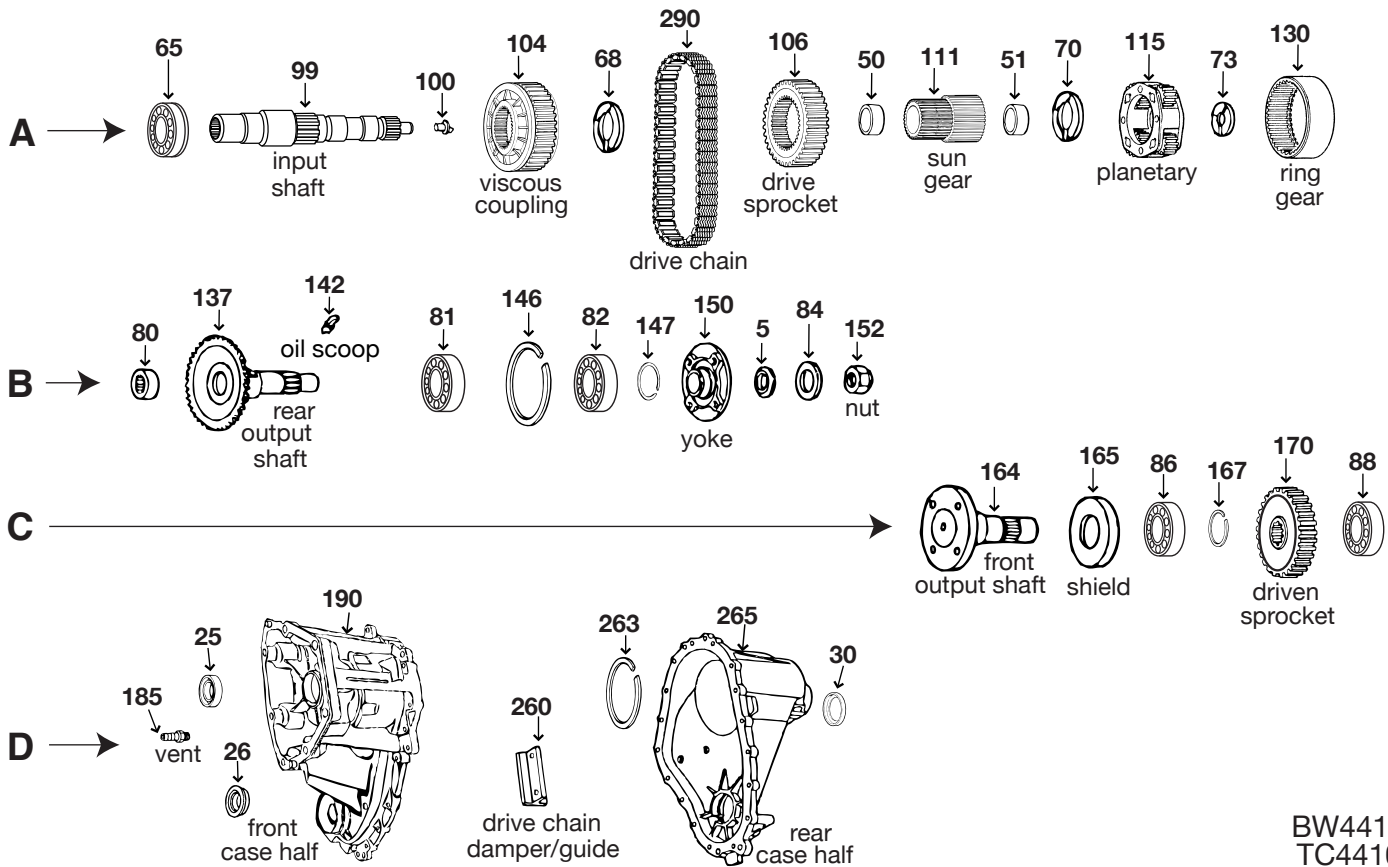

BW4410  
TC4410

| ILL                                  | DESCRIPTION                             |                               | QTY | YEAR  | REFERENCE #  | PART #            |
|--------------------------------------|---|-------------------------------|-----|-------|--------------|-------------------|
| <b>REBUILDER KITS</b>                |   |                               |     |       |              |                   |
| n/i                                  | Kit, bearings/seals                     | BW4410 (Explorer/Mountaineer) | 1   | 02-06 | TCRK-4410    | <b>TK-4410</b>    |
| n/i                                  | Kit, gaskets/seals                      | BW4410 (Explorer/Mountaineer) | 1   | 02-06 | DTK-4410     | <b>K105-964</b>   |
| <b>GASKETS AND RUBBER COMPONENTS</b> |   |                               |     |       |              |                   |
| n/i                                  | Gasket                                  | extension housing to adapter  | 1   | 02-06 | n/a          | <b>13597</b>      |
| <b>METAL CLAD SEALS</b>              |   |                               |     |       |              |                   |
| D25                                  | Seal, metal clad                        | front input shaft             | 1   | 02-06 | F3TZ-7B215-A | <b>205-16043</b>  |
| D26                                  | Seal, metal clad                        | front output shaft            | 1   | 02-06 | F3TZ-7B215-A | <b>205-16043</b>  |
| D30                                  | Seal, metal clad                        | rear output shaft             | 1   | 02-06 | F3TZ-7B215-A | <b>205-16043</b>  |
| <b>WASHERS/BEARINGS/RACES/SHIMS</b>  |   |                               |     |       |              |                   |
| A65                                  | Bearing, ball .747" 3.344" od 1.772" id | front input shaft             | 1   | 02-06 | F57Z-7127-A  | <b>6209N</b>      |
| B80                                  | Bearing, caged (cup)                    | rear output shaft (inner)     | 1   | 02-06 | BCE-1816     | <b>TC1350-135</b> |
| B81                                  | Bearing, ball .708" 1.565" id 3.148" od | rear output shaft (front)     | 1   | 02-06 | 12353016     | <b>6208N</b>      |
| B82                                  | Bearing, ball .510" 1.174" id 2.166" od | rear output shaft (rear)      | 1   | 02-06 | n/a          | <b>6006</b>       |
| C86                                  | Bearing, ball .671" 1.377" id 2.837" od | front output shaft (front)    | 1   | 02-06 | 15580228     | <b>6207N</b>      |
| C88                                  | Bearing, ball .628" 1.180" id 2.435" od | front output shaft (rear)     | 1   | 02-06 | E7TZ-7025-C  | <b>6206N</b>      |



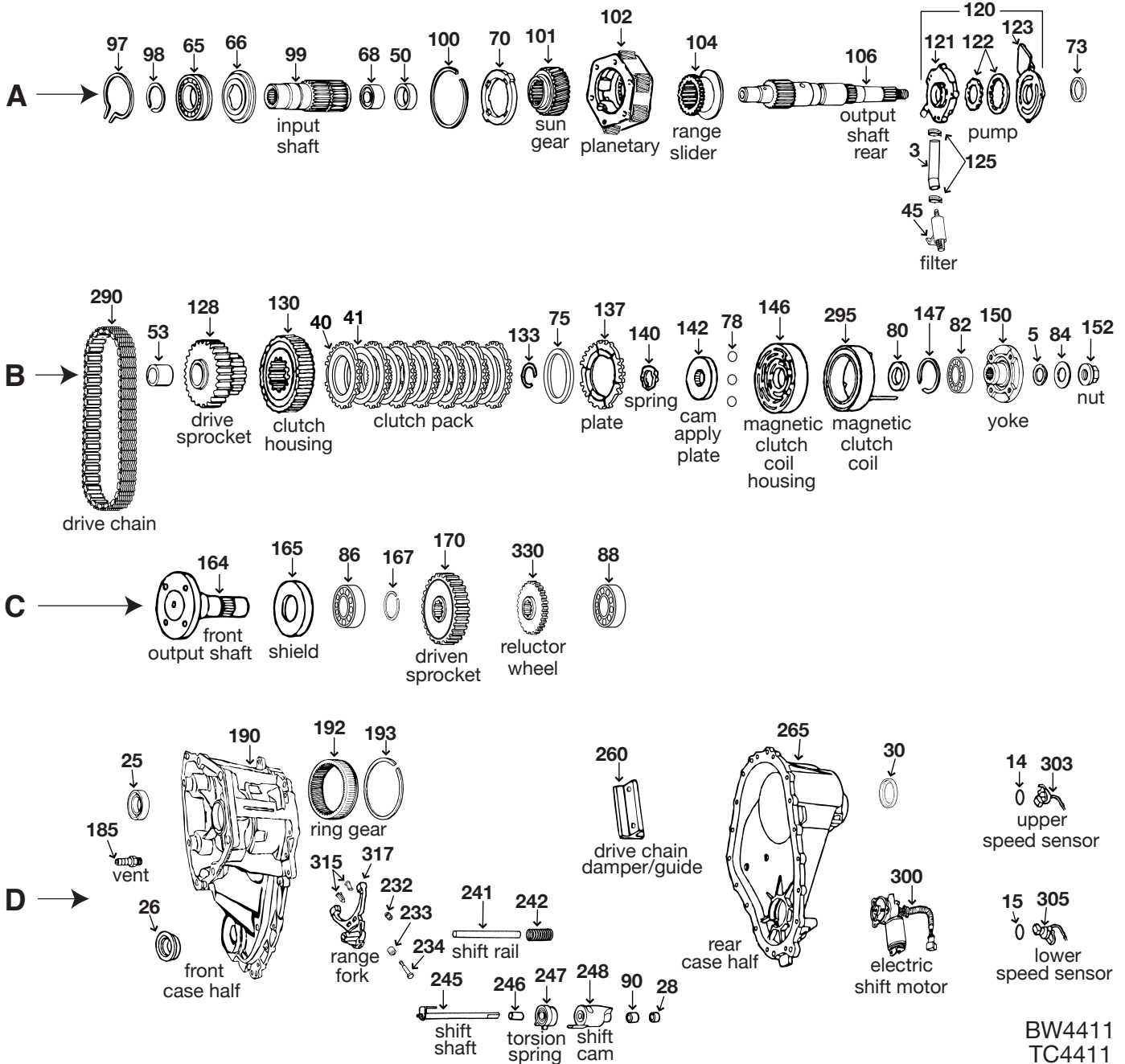

BW4411  
TC4411

| ILL                                  | DESCRIPTION                  | QTY | YEAR  | REFERENCE #  | PART #            |
|--------------------------------------|------------------------------|-----|-------|--------------|-------------------|
| <b>REBUILDER KITS</b>                |                              |     |       |              |                   |
| n/i                                  | Kit, bearing/gasket/seal     | 1   | 02-06 | TCRK-4411    | <b>TK-4411</b>    |
| n/i                                  | Kit, gasket/seal             | 1   | 02-06 | DTK-4411     | <b>K105-965</b>   |
| <b>GASKETS AND RUBBER COMPONENTS</b> |                              |     |       |              |                   |
| n/i                                  | Gasket                       | 1   | 02-06 | n/a          | <b>13597</b>      |
| <b>METAL CLAD SEALS</b>              |                              |     |       |              |                   |
| D25                                  | Seal, metal clad             | 1   | 02-06 | F3TZ-7B215-A | <b>205-16043</b>  |
| D26                                  | Seal, metal clad             | 1   | 02-06 | F3TZ-7B215-A | <b>205-16043</b>  |
| D30                                  | Seal, metal clad             | 1   | 02-06 | F3TZ-7B215-A | <b>205-16043</b>  |
| <b>CLUTCH PLATES</b>                 |                              |     |       |              |                   |
| B40                                  | Friction .078" 4.727" id 31T | 6   | 02-06 | 138731-195   | <b>TC4405-103</b> |
| B41                                  | Friction .078" 5.590" od 19T | 5   | 02-06 | 138730-195   | <b>TC4405-104</b> |
| <b>FILTERS</b>                       |                              |     |       |              |                   |
| A45                                  | Filter, oil                  | 1   | 02-06 | 400-238-002  | <b>TC4406-050</b> |





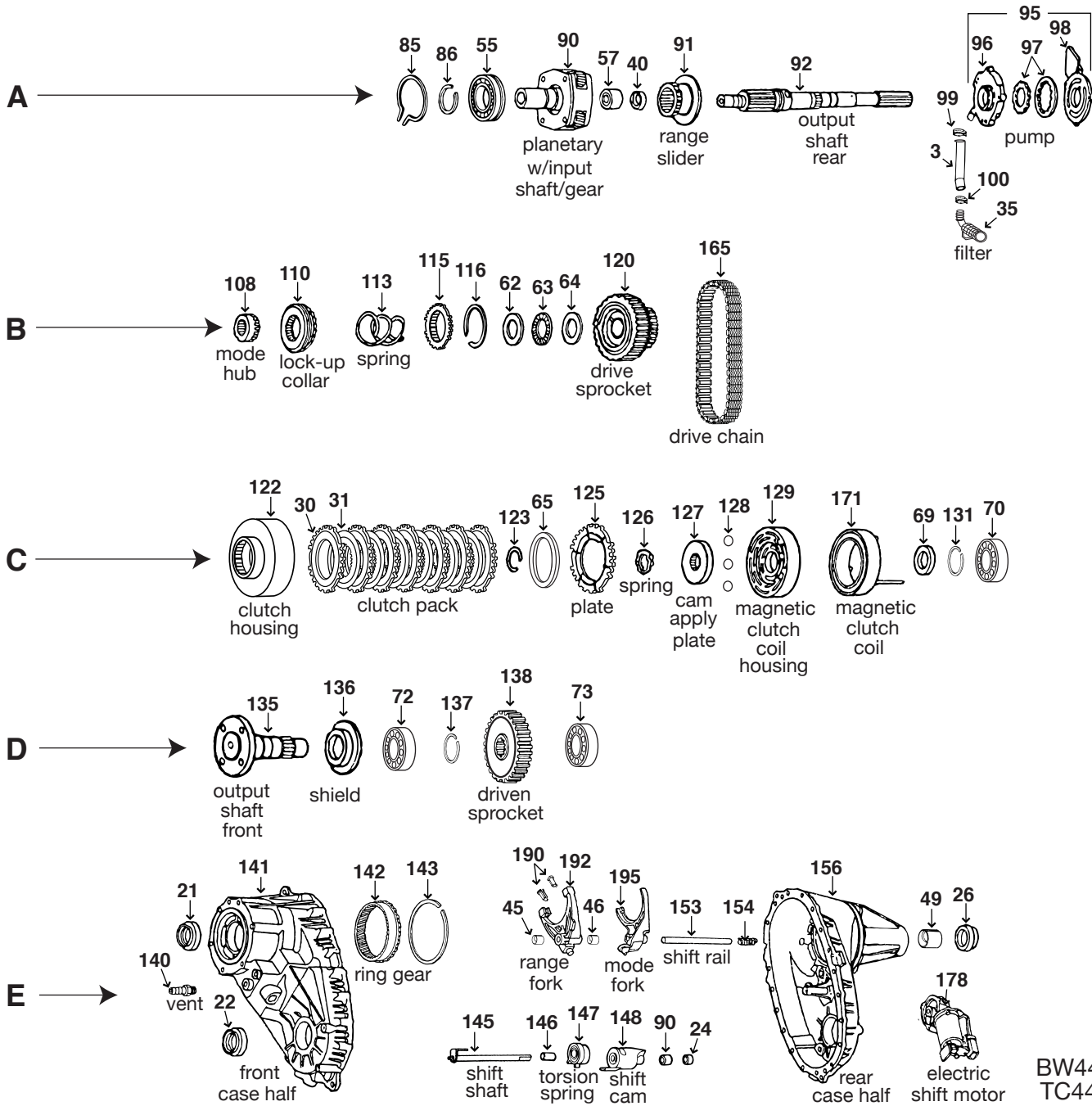

BW4416  
TC4416

| ILL                                  | DESCRIPTION                  | QTY | YEAR  | REFERENCE #  | PART #            |
|--------------------------------------|------------------------------|-----|-------|--------------|-------------------|
| <b>REBUILDER KITS</b>                |                              |     |       |              |                   |
| n/i                                  | Kit, bearing/gasket/seal     | 1   | 01-05 | TCRK-4416    | <b>TK-4416</b>    |
| n/i                                  | Kit, gasket/seal             | 1   | 01-05 | DTK-4416     | <b>K105-924</b>   |
| <b>GASKETS AND RUBBER COMPONENTS</b> |                              |     |       |              |                   |
| n/i                                  | Gasket, adapter housing      | 1   | 01-05 | 04130678     | <b>13591</b>      |
| <b>METAL CLAD SEALS</b>              |                              |     |       |              |                   |
| E21                                  | Seal, metal clad             | 1   | 01-05 | n/a          | <b>205-18771</b>  |
| E22                                  | Seal, metal clad             | 1   | 01-05 | n/a          | <b>205-18994</b>  |
| E26                                  | Seal, metal clad             | 1   | 01-05 | n/a          | <b>205-18507</b>  |
| <b>CLUTCH PLATES</b>                 |                              |     |       |              |                   |
| C30                                  | Friction .065" 4.727" id 31T | 7   | 01-06 | APC-183731   | <b>TC4406-103</b> |
| C31                                  | Friction .065" 5.590" id 19T | 6   | 01-06 | APC-183730   | <b>TC4406-104</b> |
| <b>FILTERS</b>                       |                              |     |       |              |                   |
| A35                                  | Filter, oil                  | 1   | 01-05 | 4400-235-003 | <b>TC4416-050</b> |



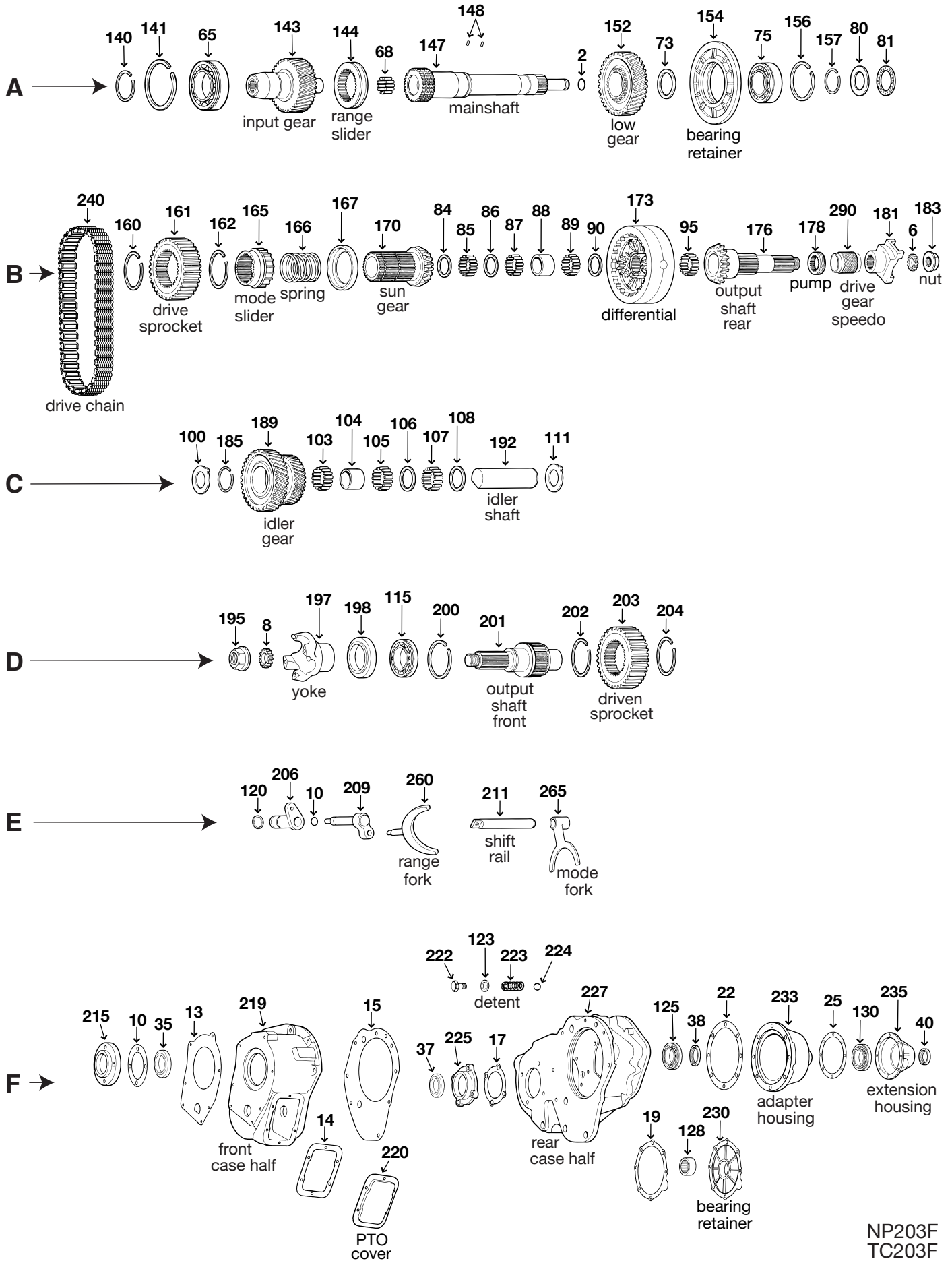

NP203F  
TC203F

| ILL                                  | DESCRIPTION                             |                                   | QTY | YEAR  | REFERENCE #  | PART #     |
|--------------------------------------|---|-----------------------------------|-----|-------|--------------|------------|
| <b>REBUILDER KITS</b>                |   |                                   |     |       |              |            |
| n/i                                  | Kit, bearing/gasket/seal                | direct mount                      | 1   | 72-79 | TCRK-203F    | TK-203B    |
| n/i                                  | Kit, bearing/gasket/seal                | remote mount                      | 1   | 72-75 | TCRK-203FA   | TK-203C    |
| n/i                                  | Kit, gasket/seal                        | direct mount                      | 1   | 72-79 | DTK-203F     | K105-905   |
| n/i                                  | Kit, gasket/seal                        | remote mount                      | 1   | 72-75 | DTK-203F     | K105-941   |
| <b>GASKETS AND RUBBER COMPONENTS</b> |   |                                   |     |       |              |            |
| A2                                   | O'ring                                  | mainshaft                         | 1   | 72-79 | 87036-S94    | 03821353   |
| B6                                   | Seal (rubber)                           | rear output yoke                  | 1   | 72-79 | D4TZ-7A385B  | 04210973   |
| D8                                   | Seal (rubber)                           | front output yoke                 | 1   | 72-79 | D4TZ-7A385B  | 04210973   |
| E10                                  | O'ring                                  | shift shaft                       | 1   | 72-79 | 377158-S     | 01536267   |
| F14                                  | Gasket, power take off cover (PTO)      | PTO gasket                        | 1   | 72-79 | B9TT-7166-C  | 3915L      |
| n/i                                  | Gasket, adapter housing                 | NP203                             | 1   | 72-79 | 04130678     | 13591      |
| <b>METAL CLAD SEALS</b>              |   |                                   |     |       |              |            |
| F35                                  | Seal, metal clad                        | input gear                        | 1   | 72-79 | D3TZ-7B215-B | 205-19255  |
| F37                                  | Seal, metal clad                        | front output shaft                | 1   | 72-79 | D4TZ-7B215-D | 205-17716  |
| F38                                  | Seal, metal clad                        | adapter housing                   | 1   | 72-79 | D4TZ-7A248-A | 205-22306  |
| F40                                  | Seal, metal clad                        | rear output shaft                 | 1   | 72-79 | D4TZ-7B215-B | 205-21061  |
| <b>WASHERS/BEARINGS/RACES/SHIMS</b>  |   |                                   |     |       |              |            |
| A65                                  | Bearing, ball .789" 1.971" id 3.545" od | input shaft                       | 1   | 72-79 | D3TZ-7065-C  | 6210N      |
| A68                                  | Bearing, needle                         | input pilot                       | a/r | 72-79 | D3TZ-7120-A  | 02954109   |
| A73                                  | Washer, thrust                          | low gear                          | 1   | 72-79 | D4TZ-7C350-A | 03821357-R |
| A75                                  | Bearing, ball .789" 1.971" id 3.545" od | mainshaft (middle)                | 1   | 72-79 | D3TZ-7065-C  | 6210N      |
| A80                                  | Washer, thrust                          | sun gear                          | 1   | 72-79 | D4TZ-7A385-A | 03821369-R |
| A81                                  | Washer, thrust                          | sun gear (lube)                   | 1   | 72-79 | D4TZ-7C341-A | 03821370   |
| B84                                  | Spacer, needle (w/o shoulder)           | sun gear (short)                  | 1   | 72-79 | D4TZ-7115-B  | 03821366-R |
| B85                                  | Bearing, needle                         | sun gear                          | a/r | 79-79 | D3TZ-7120-A  | 02954109   |
| B85                                  | Bearing, needle .125" od .935" length   | sun gear                          | a/r | 72-78 | D4TZ-7125-A  | 00666927   |
| B86                                  | Spacer, needle (w/o shoulder)           | sun gear                          | 1   | 72-79 | D4TZ-7115-B  | 03821366-R |
| B87                                  | Bearing, needle                         | sun gear                          | a/r | 79-79 | D3TZ-7120-A  | 02954109   |
| B87                                  | Bearing, needle .125" od .935" length   | sun gear                          | a/r | 72-78 | D4TZ-7125-A  | 00666927   |
| B88                                  | Spacer, needle                          | sun gear (long)                   | 1   | 72-79 | D4TZ-7115-E  | 03821367-R |
| B89                                  | Bearing, needle                         | sun gear                          | a/r | 79-79 | D3TZ-7120-A  | 02954109   |
| B89                                  | Bearing, needle .125" od .935" length   | sun gear                          | a/r | 72-78 | D4TZ-7125-A  | 00666927   |
| B90                                  | Spacer, needle (w/o shoulder)           | sun gear                          | 1   | 72-79 | D4TZ-7115-B  | 03821366-R |
| B95                                  | Bearing, needle                         | rear output shaft (front)         | a/r | 72-79 | D3TZ-7120-A  | 02954109   |
| C100                                 | Washer, thrust                          | idler gear                        | 1   | 72-79 | D4TZ-7C341-B | 03821412   |
| C103                                 | Bearing, needle                         | idler gear                        | a/r | 72-79 | D3TZ-7120-A  | 02954109   |
| C104                                 | Spacer, needle                          | idler gear (long)                 | 1   | 72-79 | D4TZ-7115-A  | 03821410-R |
| C105                                 | Bearing, needle                         | idler gear                        | a/r | 72-79 | D3TZ-7120-A  | 02954109   |
| C106                                 | Spacer, needle                          | idler gear (short)                | 1   | 72-79 | D4TZ-7115-D  | 03821411-R |
| C107                                 | Bearing, needle                         | sun gear                          | a/r | 72-79 | D3TZ-7120-A  | 02954109   |
| C108                                 | Spacer, needle                          | sun gear (short)                  | 1   | 72-79 | D4TZ-7115-D  | 03821411-R |
| C111                                 | Washer, thrust                          | idler gear                        | 1   | 72-79 | D4TZ-7C341-B | 03821412   |
| D115                                 | Bearing, ball .825" 3.145" od 1.378" id | front output shaft (front)        | 1   | 72-79 | 8D-7065      | 6307N      |
| F125                                 | Bearing, ball .825" 3.145" od 1.378" id | adapter housing (front)           | 1   | 72-79 | 8D-7065      | 6307N      |
| F128                                 | Bearing, caged (closed)                 | front output shaft (rear)         | 1   | 72-79 | TYAA-7127-A  | M-28161    |
| F130                                 | Bearing, ball .825" 3.145" od 1.378" id | rear output shaft (rear)          | 1   | 72-79 | 8D-7065      | 6307N      |
| n/i                                  | Bearing, needle                         | differential pinion gears         | 132 | 72-79 | D4TZ-7A672-A | 03821384   |
| <b>HARD PARTS</b>                    |   |                                   |     |       |              |            |
| A140                                 | Snap ring                               | NP203 input bearing on input gear | 1   | 72-79 | D3TZ-7070-E  | 03821557-R |
| A143                                 | Gear, input 28 splines 6 13/16"         | NP203                             | 1   | 72-79 | D4TZ-7158-A  | 00011895-R |
| A143                                 | Gear, input 31 splines 4 25/32"         | NP203                             | 1   | 72-79 | D4TZ-7017-A  | 00011874   |
| A144                                 | Sleeve, range slider                    | NP203                             | 1   | 72-79 | D4TZ-7100-B  | 03821362   |
| A147                                 | Shaft, main                             | NP203                             | 1   | 72-79 | D4TZ-7017-B  | 03821352-R |





T-1256 Parts List

The Ultimate Engine Hanger

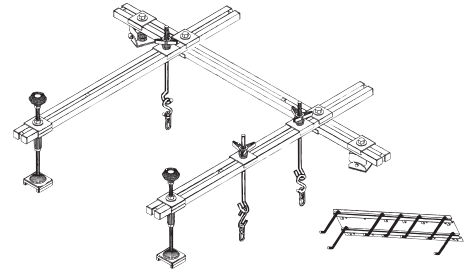

012-128 front leg (2)



012-127 2-link chain (3)



012-115 bottom bracket w/nut (2)



012-116 shock tower bracket (2)



012-120 s-hook (3)



012-118 j-hook (3)



012-019 shock tower adapter (2)



012-111 3" 1/2" thread bolt (2)



012-125 lower front leg bracket (2)



012-112 2" 1/2" thread bolt (2)



012-126 top support bracket (9)



012-109 square poly plug (12)



012-124 thrust bearing (3)



012-121 wall hanger (1)



012-110 1/2" flat washer (6)



012-123 front leg rubber pad (2)



012-114 1/2" jam nut (2)



012-108 wall hanger peg (7)



012-117 j-hook handle (3)



012-113 1/2" hex nut (2)

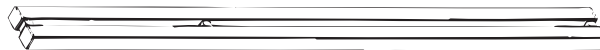

012-106 side cross bar (2)



012-122 front leg handle (2)

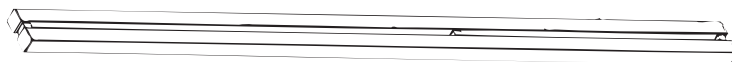

012-107 cross bar (1)

all parts are sold separately

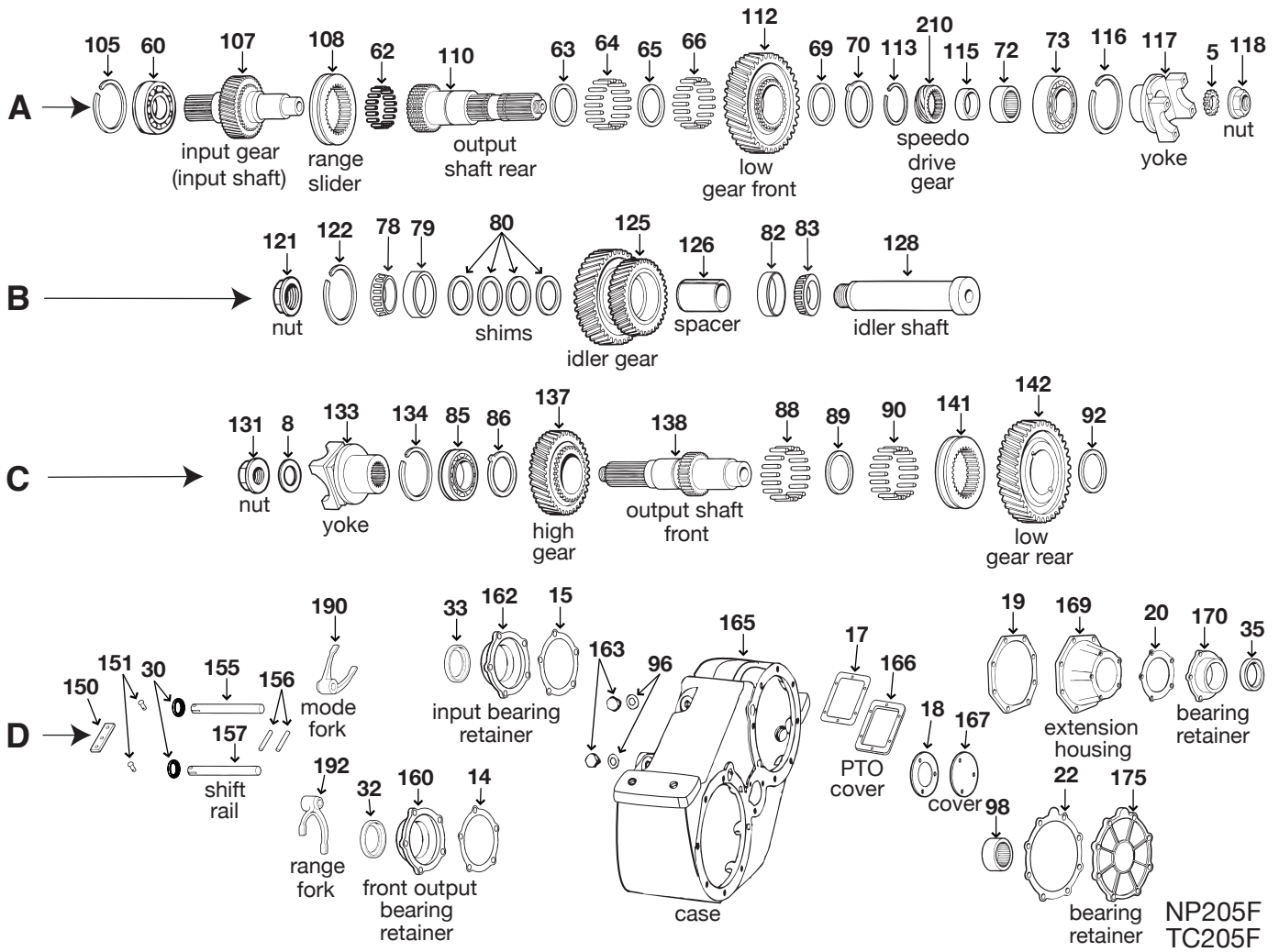

NP205F  
TC205F

| ILL                                  | DESCRIPTION                             | QTY | YEAR  | REFERENCE #  | PART #            |
|--------------------------------------|---|-----|-------|--------------|-------------------|
| <b>REBUILDER KITS</b>                |   |     |       |              |                   |
| n/i                                  | Kit, bearing/gasket/seal                | 1   | 71-89 | TCRK-205F    | <b>TK-205C</b>    |
| n/i                                  | Kit, bearing/gasket/seal                | 1   | 71-77 | TCRK-205FA   | <b>TK-205D</b>    |
| n/i                                  | Kit, gasket/seal                        | 1   | 71-89 | DTK-205F     | <b>K105-919</b>   |
| n/i                                  | Kit, gasket/seal                        | 1   | 71-77 | DTK-205FA    | <b>K105-942</b>   |
| <b>GASKETS AND RUBBER COMPONENTS</b> |   |     |       |              |                   |
| A5                                   | Seal (rubber)                           | 1   | 71-89 | D4TZ-7B368-A | <b>04210973</b>   |
| A8                                   | Seal (rubber)                           | 1   | 71-89 | D4TZ-7B368-A | <b>04210973</b>   |
| D17                                  | Gasket, power take off cover (PTO)      | 1   | 71-89 | B9TT-7166-C  | <b>3915L</b>      |
| n/i                                  | Gasket, adapter housing                 | 1   | 71-89 | 04130678     | <b>13591</b>      |
| <b>METAL CLAD SEALS</b>              |   |     |       |              |                   |
| D30                                  | Seal, metal clad                        | 2   | 71-89 | D3TZ-7288-A  | <b>205-7464</b>   |
| D32                                  | Seal, metal clad                        | 1   | 71-89 | D3TZ-7B215-A | <b>205-21213</b>  |
| D33                                  | Seal, metal clad                        | 1   | 71-89 | D3TZ-7B215-A | <b>205-21213</b>  |
| D35                                  | Seal, metal clad                        | 1   | 71-89 | D3TZ-7B215-A | <b>205-21213</b>  |
| <b>WASHERS/BEARINGS/RACES/SHIMS</b>  |   |     |       |              |                   |
| A60                                  | Bearing, ball .825" 3.145" od 1.378" id | 1   | 71-89 | 8D-7065      | <b>6307N</b>      |
| A60                                  | Bearing, ball .789" 1.971" id 3.545" od | 1   | 71-98 | D3TZ-7065-C  | <b>6210N</b>      |
| A62                                  | Bearing, needle                         | 15  | 71-89 | D3TZ-7120-A  | <b>02954109</b>   |
| A63                                  | Washer, thrust (w/tab)                  | 1   | 71-89 | D3TZ-7067-A  | <b>03491282-R</b> |
| A64                                  | Bearing, needle                         | 32  | 71-89 | D3TZ-7A672-A | <b>01949834</b>   |
| A65                                  | Spacer, needle                          | 1   | 71-89 | D3TZ-7080-A  | <b>02954112-R</b> |
| A66                                  | Bearing, needle                         | 32  | 71-89 | D3TZ-7A672-A | <b>01949834</b>   |

| ILL   | DESCRIPTION                             |                           | QTY | YEAR  | REFERENCE #  | PART #     |
|---|---|---------------------------|-----|-------|--------------|------------|
| <b>WASHERS/BEARINGS/RACES/SHIMS (CONTINUED)</b> |   |                           |     |       |              |            |
| A69   | Washer, thrust (w/tab)                  | low gear                  | 1   | 71-89 | D3TZ-7067-A  | 03491282-R |
| A70   | Washer, thrust (w/o tab)                | low gear                  | 1   | 71-89 | D3TZ-7067-B  | 02954113-R |
| A72   | Bearing, caged (open)                   | rear output shaft support | 1   | 71-89 | C4TZ-7127-A  | B3216      |
| A73   | Bearing, ball .825" 3.145" od 1.378" id | rear output shaft         | 1   | 71-89 | 8D-7065      | 6307N      |
| B78   | Bearing, cone                           | idler gear                | 1   | 71-89 | D3TZ-7065-A  | BR2793     |
| B79   | Bearing, cup                            | idler gear                | 1   | 71-89 | 2910220      | BR2720     |
| B82   | Bearing, cup                            | idler gear                | 1   | 71-89 | 2910220      | BR2720     |
| B83   | Bearing, cone                           | idler gear                | 1   | 71-89 | D3TZ-7065-A  | BR2793     |
| C85   | Bearing, ball .825" 3.145" od 1.378" id | front output shaft        | 1   | 71-89 | 8D-7065      | 6307N      |
| C86   | Washer, thrust (w/tab)                  | high gear                 | 1   | 71-89 | D3TZ-7067-A  | 03491282-R |
| C88   | Bearing, needle                         | low gear (lower)          | 32  | 71-89 | D3TZ-7A672-A | 01949834   |
| C89   | Spacer, needle                          | low gear (lower)          | 1   | 71-89 | D3TZ-7080-A  | 02954112-R |
| C90   | Bearing, needle                         | low gear (lower)          | 32  | 71-89 | D3TZ-7A672-A | 01949834   |
| C92   | Washer, thrust (w/o tab)                | low gear                  | 1   | 71-89 | D3TZ-7067-B  | 02954113-R |
| D98   | Bearing, caged (closed)                 | front output shaft (rear) | 1   | 71-89 | TYAA-7127-A  | M-28161    |
| <b>HARD PARTS</b>                               |   |                           |     |       |              |            |
| A105  | Ring, bearing outer                     | NP205                     | 1   | 71-89 | 02124518     | 02124518-R |
| A107  | Gear, input (32 splines)                | NP205 (remote mount)      | 1   | 71-89 | D3TZ-7017-A  | 02954104   |
| A107  | Gear, input (31 splines)                | NP205 (direct mount)      | 1   | 71-89 | D7TZ-7017-B  | 00011656   |
| A108  | Sleeve, sliding                         | NP205 (range)             | 1   | 71-89 | D3TZ-7100-B  | 02954116   |
| A110  | Shaft, rear output (w/bolt-on yoke)     | 34-38-32-8-13/16L         | 1   | 71-89 | D3TZ-7061-B  | 04106561   |
| A112  | Gear, 25T                               | NP205 (low gear upper)    | 1   | 71-89 | D3TZ-7100-C  | 02952589-R |
| A115  | Spacer, sleeve                          | rear output shaft         | 1   | 71-89 | 02225025     | 02225025-R |
| A116  | Ring, bearing outer                     | rear output shaft         | 1   | 71-89 | 02124518     | 02124518-R |
| A118  | Nut                                     | NP205                     | 1   | 71-89 | 372631S      | 02954140-R |
| B121  | Nut                                     | idler gear                | 1   | 71-89 | 372631S      | 02954140-R |
| B125  | Gear, idler                             | NP205                     | 1   | 71-89 | D3TZ-7142-A  | 02954119-R |
| B126  | Spacer, idler gear bearing              | NP205                     | 1   | 71-89 | D3TZ-7125-A  | 02954121-R |
| B128  | Shaft, idler                            | NP205                     | 1   | 71-89 | D3TZ-7140-A  | 02954122-R |
| C131  | Nut                                     | front output shaft        | 1   | 71-89 | 372631S      | 02954140-R |
| C134  | Ring, bearing outer                     | front output shaft        | 1   | 71-89 | 02124518     | 02124518-R |
| C137  | Gear, 35T                               | NP205                     | 1   | 71-89 | D3TZ-7100-A  | 02954124-R |
| C138  | Shaft, front output                     | 34-32-9 3/8" Length       | 1   | 71-89 | D3TZ-7061-A  | 03491281-R |
| C141  | Sleeve, sliding                         | NP205 (mode)              | 1   | 71-89 | D3TZ-7100-B  | 02954116   |
| C142  | Gear, 25T                               | NP205 (low gear lower)    | 1   | 71-89 | D3TZ-7100-C  | 02952589-R |
| D150  | Link, shift rail                        | NP205                     | 1   | 71-89 | D3TZ-7B106-A | 03732041-R |
| D155  | Shaft, rear shift                       | 3/4" od x 7 3/32" length  | 1   | 71-89 | D3TZ-7240-A  | 00011405-R |
| D157  | Shift, front shift                      | 3/4" od x 8 3/4" length   | 1   | 71-89 | D3TZ-7240-B  | 00011406-R |
| D167  | Cover, idler shaft                      | NP205                     | 1   | 71-89 | D3TZ-7085-C  | 00927365-R |
| D170  | Retainer, rear output shaft bearing     | 1 3/16 wide               | 1   | 71-89 | D3TZ-7085-A  | 02954134-R |
| D175  | Retainer, front output shaft            | NP205                     | 1   | 71-89 | D3TZ-7085-A  | 02954130-R |
| n/i   | Pin, thrust washer                      | NP205                     | 2   | 71-89 | D3TZ-7C018-A | 02952592-R |
| <b>SHIFT FORKS AND PADS</b>                     |   |                           |     |       |              |            |
| D190  | Fork, shift                             | NP205 (mode)              | 1   | 71-89 | D3TZ-7289-A  | 02954135-R |
| D192  | Fork, shift                             | NP205 (range)             | 1   | 71-89 | D3TZ-7289-A  | 02954135-R |
| <b>NOTES</b>                                    |   |                           |     |       |              |            |
|   |   |                           |     |       |              |            |
|   |   |                           |     |       |              |            |
|   |   |                           |     |       |              |            |
|   |   |                           |     |       |              |            |
|   |   |                           |     |       |              |            |
|   |   |                           |     |       |              |            |
|   |   |                           |     |       |              |            |

NP205F

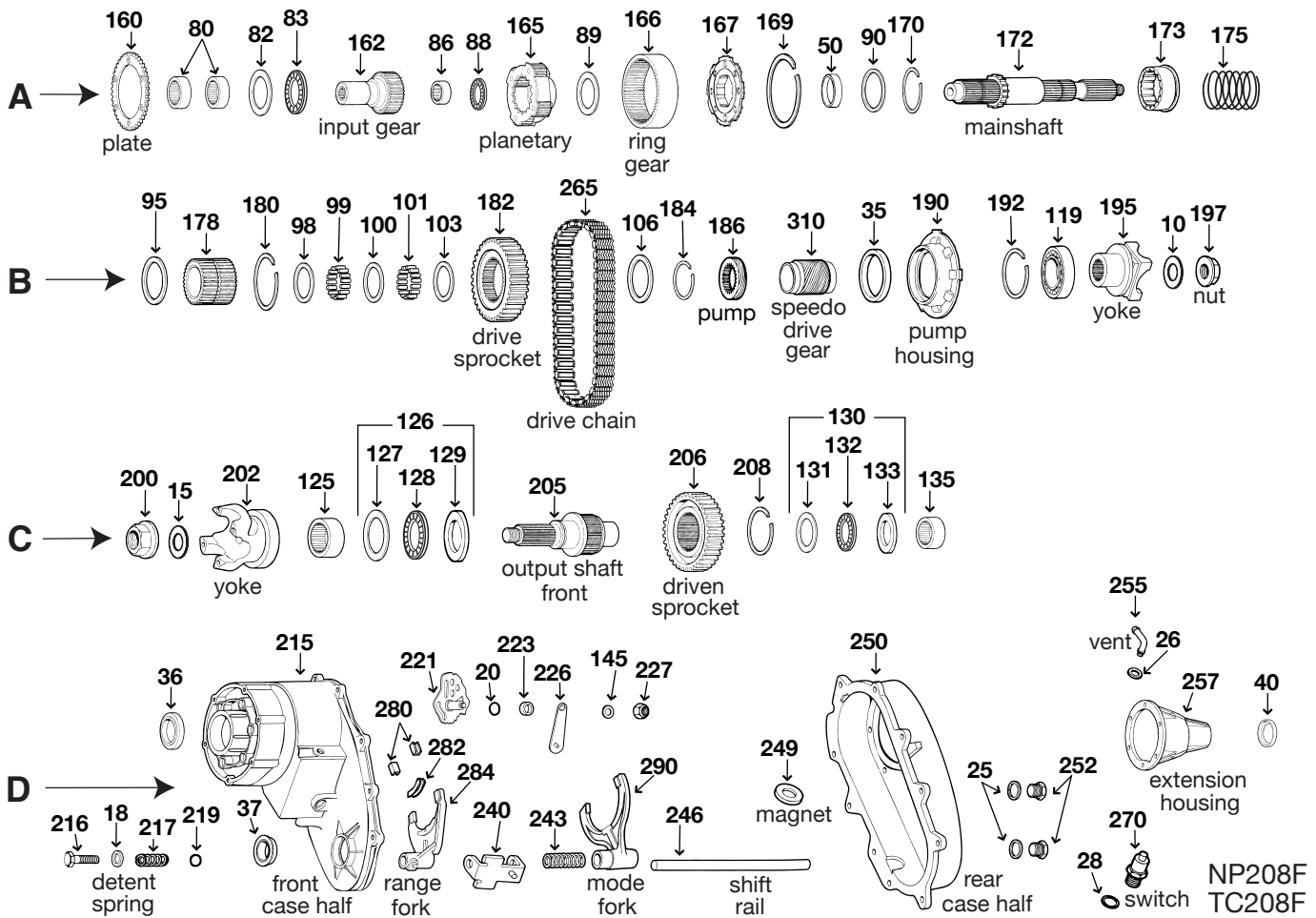

NP208F  
TC208F

| ILL                                  | DESCRIPTION                            | QTY | YEAR  | REFERENCE #  | PART #     |
|--------------------------------------|--|-----|-------|--------------|------------|
| <b>REBUILDER KITS</b>                |  |     |       |              |            |
| n/i                                  | Kit, bearing/gasket/seal               | 1   | 80-86 | TCRK-208FA   | TK-208A    |
| n/i                                  | Kit, gasket/seal                       | 1   | 80-86 | DTC-208      | K105-908   |
| n/i                                  | Kit, small parts                       | 1   | 80-86 | AE           | SP208-50   |
| <b>GASKETS AND RUBBER COMPONENTS</b> |  |     |       |              |            |
| B10                                  | Seal (rubber)                          | 1   | 80-86 | D4TZ-7B368-A | 04210973   |
| C15                                  | Seal (rubber)                          | 1   | 80-86 | D4TZ-7B368-A | 04210973   |
| D20                                  | O'ring                                 | 1   | 80-86 | 370367S      | 3547L      |
| n/i                                  | Gasket, adapter housing                | 1   | 80-86 | 04130678     | 13591      |
| <b>METAL CLAD SEALS</b>              |  |     |       |              |            |
| B35                                  | Seal, metal clad                       | 1   | 80-86 | E0TZ-7B215-A | 205-22306  |
| D36                                  | Seal, metal clad                       | 1   | 80-86 | 205-19255    | 205-19255  |
| D37                                  | Seal, metal clad                       | 1   | 80-86 | E0TZ-7B215-B | 205-18771  |
| D40                                  | Seal, metal clad                       | 1   | 80-86 | D9TZ-7B215-A | 205-18771  |
| <b>BUSHINGS</b>                      |  |     |       |              |            |
| A50                                  | Bushing, ring gear                     | 1   | 80-86 | 00013721     | 00013721   |
| <b>WASHERS/BEARINGS/RACES/SHIMS</b>  |  |     |       |              |            |
| A80                                  | Bearing, caged (cup) 2 9/32" od        | 2   | 80-86 | E0TZ-7120-A  | 04269185   |
| A82                                  | Washer, thrust 3/32" thick 2" id       | 1   | 80-86 | 4167933      | 04167933-R |
| A83                                  | Bearing, thrust 1 31/32" id            | 1   | 80-86 | E0TZ-7C096-A | 04167934   |
| A86                                  | Bearing, caged 1.500" od               | 1   | 80-86 | E0TZ-7065-A  | 04269187   |
| A88                                  | Bearing, thrust                        | 1   | 80-86 | E1TZ-7C096-B | 04269182   |
| A89                                  | Washer, thrust 3.435" od               | 1   | 80-86 | E0TZ-7D484-A | 04167953   |
| A90                                  | Washer, thrust                         | 1   | 80-86 | 4219064      | 04219064-R |
| B95                                  | Washer, thrust 1/32" thick 2 19/64" id | 1   | 80-86 | E1TZ-7A385-A | 04269177-R |
| B98                                  | Spacer, sprocket carrier rollers       | 1   | 80-86 | E0TZ-7115-A  | 04167985-R |



| ILL   | DESCRIPTION                             |                                 | QTY | YEAR  | REFERENCE #  | PART #     |
|---|---|---------------------------------|-----|-------|--------------|------------|
| <b>WASHERS/BEARINGS/RACES/SHIMS (CONTINUED)</b> |   |                                 |     |       |              |            |
| B99   | Bearing, needle .125" od .935" length   | sprocket carrier                | 60  | 80-86 | D4TZ-7145-A  | 00666927   |
| B100  | Spacer, sprocket carrier rollers        | NP208                           | 1   | 80-86 | E0TZ-7115-A  | 04167985-R |
| B101  | Bearing, needle .125" od .935" length   | NP208                           | 60  | 80-86 | D4TZ-7145-A  | 00666927   |
| B103  | Spacer, sprocket carrier rollers        | NP203                           | 1   | 80-86 | E0TZ-7115-A  | 04167985-R |
| B106  | Washer, thrust 5/32" 2 16/64" id        | sprocket thrust                 | 1   | 83-86 | E3TZ-7C341-A | 04329330-R |
| B106  | Washer, thrust 2 19/64" id 5/32" thick  | sprocket thrust                 | 1   | 80-82 | E1TZ-7C341-A | 04219091-R |
| B119  | Bearing, ball .671" 1.377" id 2.837" od | rear output shaft               | 1   | 80-86 | C3AZ-7025-B  | 6207N      |
| C125  | Bearing, caged 2.125" od                | front output shaft (front)      | 1   | 80-86 | E0TZ-7127-B  | B2816      |
| C127  | Washer, thrust 3/32" thick              | front output shaft (front)      | 1   | 80-86 | E0TZ-7119-A  | 04167992   |
| C128  | Bearing, thrust 1.750" id 2.500" od     | front output shaft (front)      | 1   | 80-86 | E0TZ-D234-A  | 04167993   |
| C129  | Washer, thrust 1/32" thick              | front output shaft (front)      | 1   | 80-86 | E0TZ-7119-B  | 04167994   |
| C131  | Washer, thrust 3/32" thick              | front output shaft (rear)       | 1   | 80-86 | E0TZ-7119-A  | 04167992   |
| C132  | Bearing, thrust 1.750" id 2.500" od     | front output shaft (rear)       | 1   | 80-86 | E0TZ-D234-A  | 04167993   |
| C133  | Washer, thrust 1/32" thick              | front output shaft (rear)       | 1   | 80-86 | E0TZ-7119-B  | 04167994   |
| C135  | Bearing, caged (open) 1.875" od         | front output shaft (rear)       | 1   | 80-86 | E0TZ-7127-A  | 04269189   |
| <b>HARD PARTS</b>                               |   |                                 |     |       |              |            |
| A160  | Plate, low range lock 31T               | NP208                           | 1   | 80-86 | E0TZ-7B442-A | 04167931-R |
| A162  | Gear, input drive 45T (31 splines)      | 31 splines 5 5/64" length       | 1   | 80-86 | E0TZ-7017-A  | 00013779-R |
| A165  | Gear, planetary assembly                | NP208                           | 1   | 80-86 | E0TZ-7A398-A | 04329198-R |
| A166  | Gear, planetary ring w/hub              | NP208                           | 1   | 80-82 | E0TZ-7A153-A | 04167954-R |
| A166  | Gear, ring w/o hub                      | NP208                           | 1   | 82-86 | E1TZ-7A153-A | 04219060-R |
| A167  | Web, hub assembly                       | NP208                           | 1   | 82-86 | 4295115      | 04295115   |
| A170  | Snap ring 3" od                         | 2 5/8" id 3" od                 | 1   | 80-86 | D4TZ-7917-A  | 03821372-R |
| A172  | Shaft, rear output w/hub                | 52-16-38T 14 23/64" length      | 1   | 80-86 | E3TZ-7061-L  | 04329194-R |
| B178  | Carrier, sprocket 32T                   | NP208                           | 1   | 80-86 | E0TZ-7C115-B | 04269214-R |
| B180  | Snap ring                               | 3 1/6" id 3/32" thick           | 1   | 80-86 | E0TZ-7917-C  | 04167984-R |
| B182  | Sprocket, drive                         | 32T internal/34T external       | 1   | 80-86 | E1TZ-7177-A  | 04269178-R |
| B184  | Ring, sprocket carrier retaining        | 2 7/64" id                      | 1   | 80-86 | E0TZ-7917-A  | 04167987-R |
| B186  | Pump, oil 38 splines (nylon)            | 2 7/32" od                      | 1   | 80-86 | D8TZ-7C010-A | 03894957   |
| B190  | Housing, oil pump                       | NP208                           | 1   | 80-86 | E0TZ-7A151-A | 04210602   |
| B192  | Ring, bearing retainer                  | NP208                           | 1   | 80-86 | 4210984      | 04210984-R |
| B197  | Nut                                     | NP208 (rear output shaft yoke)  | 1   | 80-86 | 04167924     | 04167924-R |
| C200  | Nut                                     | NP208 (front output shaft yoke) | 1   | 80-86 | 04167924     | 04167924-R |
| C205  | Shaft, front output 61T (32 splines)    | 6 15/16" length                 | 1   | 80-86 | E1TZ-7061-A  | 04167730-R |
| C206  | Sprocket, driven 61T                    | NP208                           | 1   | 80-86 | E1TZ-7177-B  | 04746259-R |
| D221  | Shaft, w/rooster cone                   | NP208                           | 1   | 80-86 | E0TZ-7F063-A | 00013722-R |
| D243  | Spring, shift mode fork                 | NP208                           | 1   | 80-86 | E0TZ-7219-A  | 04167975-R |
| D246  | Rail, shift                             | 5/8" od 8 11/16" length         | 1   | 80-86 | E0TZ-7240-A  | 04167965-R |
| D252  | Plug w/gasket                           | NP208                           | 2   | 80-86 | E0TZ-7A010-A | 04210616-R |
| n/i   | Bolt, extension/case                    | NP208                           | 4   | 80-86 | E0TZ-7A443-A | 04210617-R |
| <b>TRANSFER CASE CHAINS</b>                     |   |                                 |     |       |              |            |
| B265  | Chain, drive 84 links 1.250" wide (RP)  | NP208                           | 1   | 80-86 | E0TZ-7A029-A | HV-012     |
| <b>ELECTRICAL COMPONENTS</b>                    |   |                                 |     |       |              |            |
| D270  | Switch, lockout                         | NP208                           | 1   | 80-86 | E0TZ-7E440-A | 04168000   |
| <b>SHIFT FORKS AND PADS</b>                     |   |                                 |     |       |              |            |
| D280  | Pad, fork (nylon)                       | range                           | 2   | 80-81 | 04167969     | 04167969   |
| D282  | Pad, fork (nylon)                       | range                           | 1   | 80-81 | 04167970     | 04167970   |
| D284  | Fork, range shift                       | NP208                           | 1   | 80-81 | E1TZ-7289-A  | 00015111-R |
| D284  | Fork, range shift                       | NP208 (webb style hub )         | 1   | 82-86 | E1TZ-7289-B  | 00015380   |
| D290  | Fork, shift mode                        | 3 31/32" span                   | 1   | 80-86 | E0TZ-7289-B  | 04167974-R |
| <b>SPEEDO GEARS</b>                             |   |                                 |     |       |              |            |
| B310  | Gear, speedo drive 8T                   | NP208                           | 1   | 80-86 | D5TZ-17285-A | 00013172   |
| B310  | Gear, speedo drive 7T                   | NP208                           | 1   | 80-86 | C3TZ-17285-A | 00011392   |

NP208F

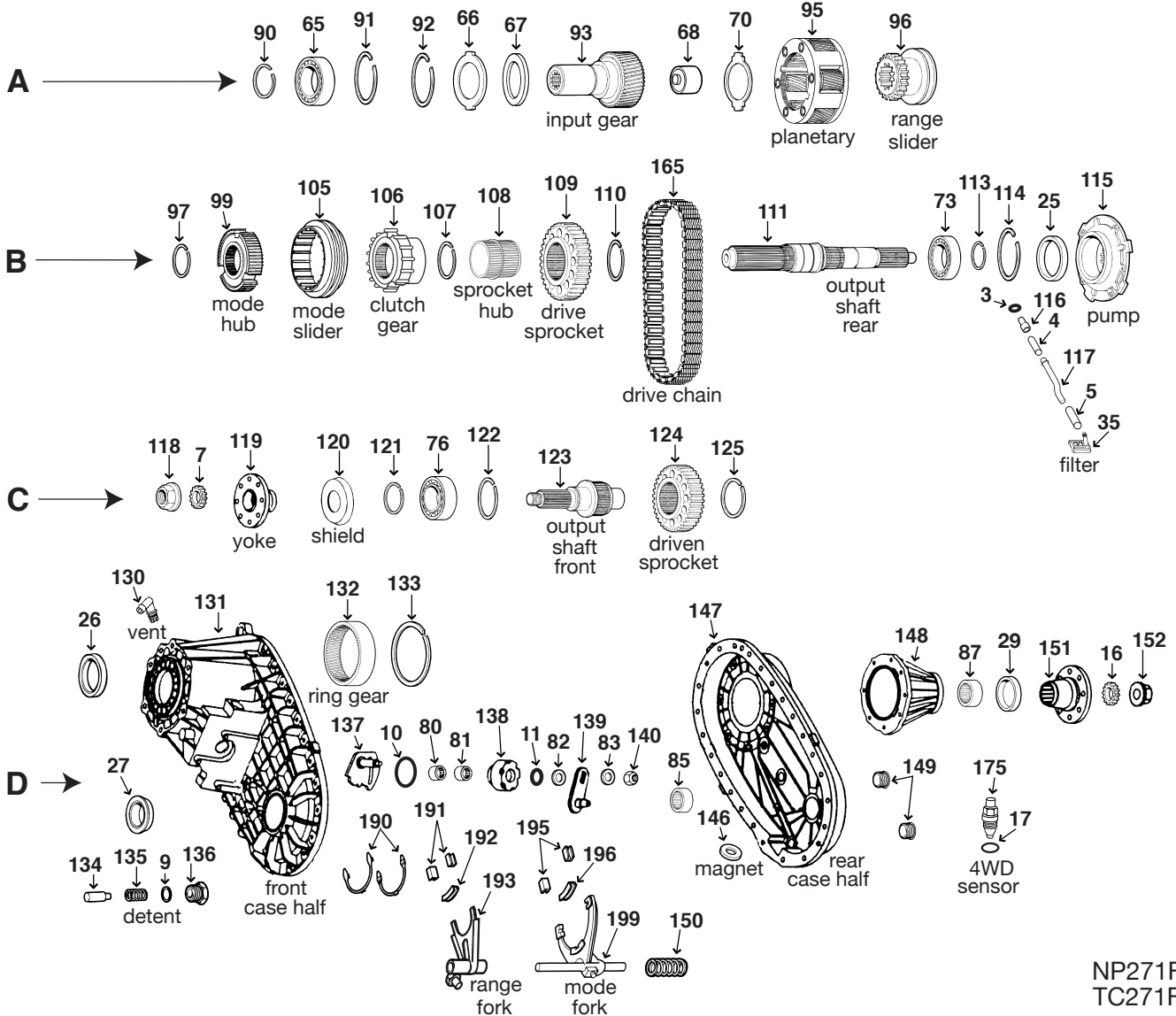

NP271F  
TC271F

| ILL                                  | DESCRIPTION                             | QTY | YEAR  | REFERENCE #   | PART #     |          |
|--------------------------------------|---|-----|-------|---------------|------------|----------|
| <b>REBUILDER KITS</b>                |   |     |       |               |            |          |
| n/i                                  | Kit, bearing/gasket/seal                |     | NV271 | 1             | 99-08 AE   | TK-271   |
| n/i                                  | Kit, gasket/seal                        |     | NV271 | 1             | 99-08 AE   | K105-922 |
| <b>GASKETS AND RUBBER COMPONENTS</b> |   |     |       |               |            |          |
| B3                                   | O'ring                                  | 1   | 99-08 | n/a           | TC231-018  |          |
| n/i                                  | Gasket, adapter housing                 | 1   | 99-08 | 04130678      | 13591      |          |
| <b>METAL CLAD SEALS</b>              |   |     |       |               |            |          |
| B25                                  | Seal, metal clad                        | 1   | 99-08 | E0TZ-7B215-A  | 205-22306  |          |
| D26                                  | Seal, metal clad                        | 1   | 99-08 | F81Z-7B215-AA | 205-21239  |          |
| D27                                  | Seal, metal clad                        | 1   | 99-08 | F81Z-7B215-BA | 205-21241  |          |
| D29                                  | Seal, metal clad                        | 1   | 99-08 | F81Z-7B215-BA | 205-21241  |          |
| <b>FILTERS</b>                       |   |     |       |               |            |          |
| B35                                  | Filter, oil screen                      | 1   | 99-08 | F81Z-7A098-AB | TC241-050  |          |
| <b>WASHERS/BEARINGS/RACES/SHIMS</b>  |   |     |       |               |            |          |
| A65                                  | Bearing, ball .830" 3.935" od 2.165" id | 1   | 99-08 | F71Z-7025-AA  | 6211L      |          |
| A68                                  | Bearing, caged (cup)                    | 1   | 99-08 | F71Z-7120-AA  | TC271-169  |          |
| B73                                  | Bearing, ball                           | 1   | 99-08 | F81Z-7015-AA  | 6212N      |          |
| C76                                  | Bearing, ball .709" 3.539" od 2.164" id | 1   | 99-08 | F81Z-7025-BA  | 6011N      |          |
| D85                                  | Bearing, caged (cup)                    | 1   | 99-08 | F81Z-7127-AA  | TC271-125  |          |
| D87                                  | Bearing, caged (open)                   | 1   | 99-08 | F81Z-7118-BA  | TC271F-128 |          |



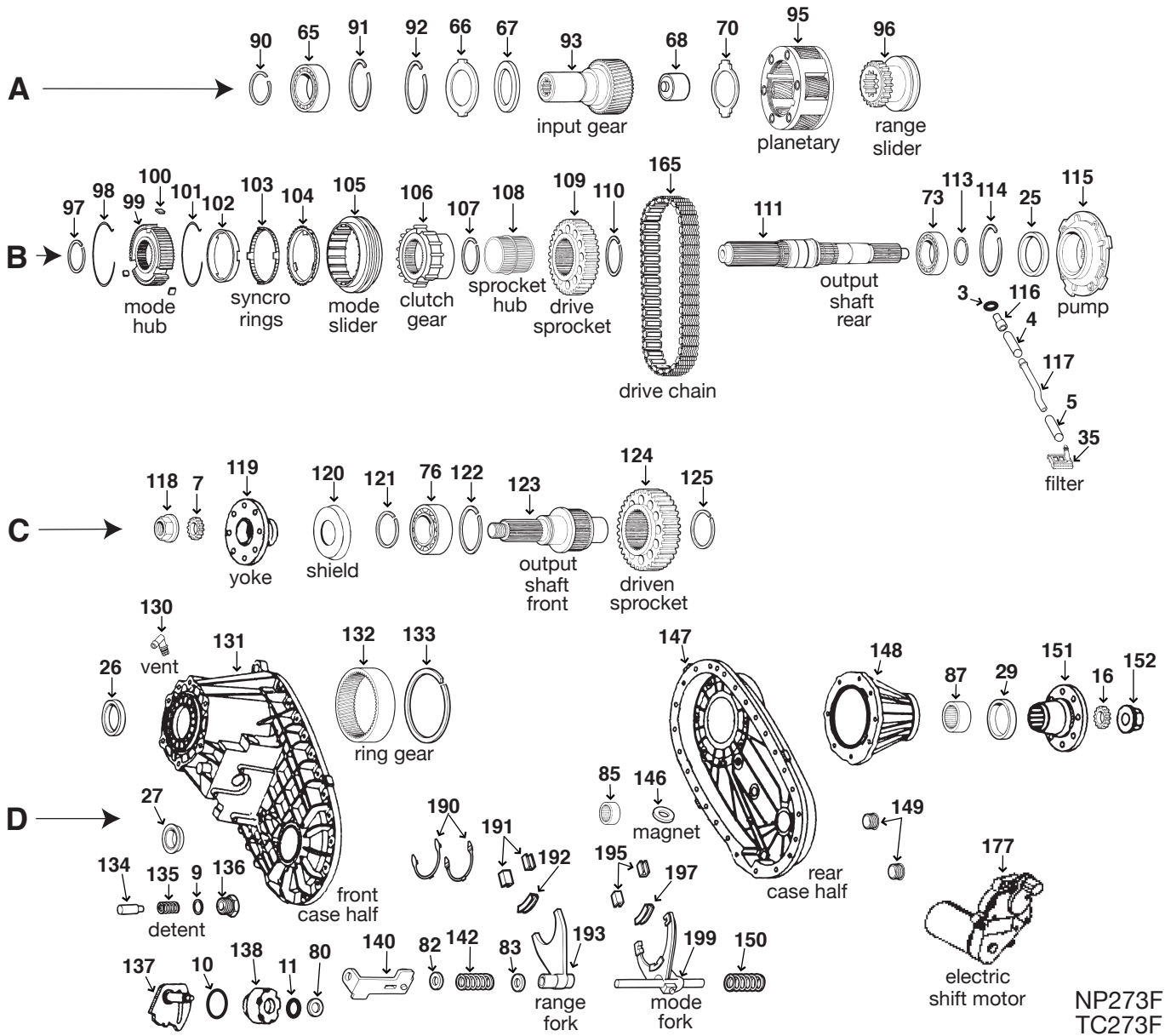

NP273F  
TC273F

| ILL                                  | DESCRIPTION                             | QTY | YEAR  | REFERENCE #   | PART #    |
|--------------------------------------|---|-----|-------|---------------|-----------|
| <b>REBUILDER KITS</b>                |   |     |       |               |           |
| n/i                                  | Kit, bearing/gasket/seal                | 1   | 99-08 | AE            | TK-271    |
| n/i                                  | Kit, gasket/seal                        | 1   | 99-08 | AE            | K105-922  |
| <b>GASKETS AND RUBBER COMPONENTS</b> |   |     |       |               |           |
| B3                                   | O'ring                                  | 1   | 99-08 | n/a           | TC231-018 |
| n/i                                  | Gasket, adapter housing                 | 1   | 99-08 | 04130678      | 13591     |
| <b>METAL CLAD SEALS</b>              |   |     |       |               |           |
| B25                                  | Seal, metal clad                        | 1   | 99-08 | E0TZ-7B215-A  | 205-22306 |
| D26                                  | Seal, metal clad                        | 1   | 99-08 | F81Z-7B215-AA | 205-21239 |
| D27                                  | Seal, metal clad                        | 1   | 99-08 | F81Z-7B215-BA | 205-21241 |
| D29                                  | Seal, metal clad                        | 1   | 99-08 | F81Z-7B215-BA | 205-21241 |
| <b>FILTERS</b>                       |   |     |       |               |           |
| B35                                  | Filter, oil screen                      | 1   | 99-08 | NV16217       | TC241-050 |
| <b>WASHERS/BEARINGS/RACES/SHIMS</b>  |   |     |       |               |           |
| A65                                  | Bearing, ball .830" 3.935" od 2.165" id | 1   | 99-08 | F81Z-7025-AA  | 6211L     |
| A68                                  | Bearing, caged (cup)                    | 1   | 99-08 | F71Z-7120-AA  | TC271-169 |
| B73                                  | Bearing, ball                           | 1   | 99-08 | F81Z-7015-AA  | 6212N     |
| C76                                  | Bearing, ball .709" 3.539" od 2.164" id | 1   | 99-08 | F81Z-7025-BA  | 6011N     |

| ILL   | DESCRIPTION   | QTY | YEAR  | REFERENCE #   | PART #       |
|---|---|-----|-------|---------------|--------------|
| <b>WASHERS/BEARINGS/RACES/SHIMS (CONTINUED)</b> |   |     |       |               |              |
| D85   | Bearing, caged (cup) front output shaft (rear)      | 1   | 99-08 | F81Z-7127-AA  | TC271-125    |
| D87   | Bearing, caged (open) rear extension housing        | 1   | 99-08 | F81Z-7118-BA  | TC271F-128   |
| <b>HARD PARTS</b>                               |   |     |       |               |              |
| A93   | Gear, front input 24T NV273                         | 1   | 99-08 | F81Z-7017-BA  | TC271F-170   |
| A93   | Gear, front input 34T NV273                         | 1   | 99-08 | NV44631       | TC271F-171   |
| A93   | Gear, front input 31T NV273                         | 1   | 99-08 | F81Z-7017-AA  | TC271F-172   |
| A95   | Gear, planetary (narrow teeth) NV273                | 1   | 99-08 | F81Z-7A398-AA | TC241-161    |
| A95   | Gear, planetary (narrow teeth) NV273                | 1   | 99-08 | AE            | TC241-161-R  |
| A96   | Hub, range shift 1.970" oh NV273                    | 1   | 99-02 | F81Z-7100-AA  | TC247-120    |
| A96   | Hub, range shift NV273                              | 1   | 03-08 | NV38307       | TC271-178    |
| B98   | Spring, synchronizer (mode)(small) NV273            | 1   | 99-08 | AE            | 04329524-R   |
| B99   | Hub, inner synchronizer NV273                       | 1   | 99-08 | AE            | TC271-179-R  |
| B100  | Strut, synchronizer NV273                           | 3   | 99-08 | AE            | 04446459-R   |
| B101  | Spring, synchronizer (mode)(small) NV273            | 1   | 99-08 | AE            | 04329524-R   |
| B102  | Ring, inner synchronizer NV273                      | 1   | 99-08 | NV26549       | TC273-183B   |
| B103  | Ring, middle synchronizer (friction) NV373          | 1   | 99-08 | NV30130       | TC273-183A   |
| B104  | Ring, outer synchronizer NV273                      | 1   | 99-08 | NV30131       | TC273-183    |
| B105  | Sleeve, synchronizer (mode)(small) NV273            | 1   | 99-08 | AE            | TC241-140-R  |
| B106  | Gear, clutch (mode) NV273                           | 1   | 99-08 | AE            | TC271-181-R  |
| B108  | Hub, drive sprocket NV273                           | 1   | 99-08 | F81Z-7W060-BA | TC271-182-R  |
| B109  | Gear, sprocket drive                                | 1   | 99-08 | F81Z-7177-AA  | TC271-185    |
| B109  | Gear, sprocket drive                                | 1   | 99-08 | AE            | TC271-185-R  |
| B111  | Shaft, rear output NV273                            | 1   | 99-08 | AE            | TC273F-190-R |
| B111  | Shaft, rear output includes range fork/range slider | 1   | 99-08 | NV43219       | TC273F-191   |
| B115  | Pump assembly NV273                                 | 1   | 99-08 | F81Z-7A149-AA | TC271-200    |
| B115  | Pump assembly NV273                                 | 1   | 99-08 | AE            | TC271-200-R  |
| C123  | Shaft, front output NV273                           | 1   | 99-08 | F81Z-7061-BA  | TC271-205-R  |
| C124  | Gear, sprocket driven                               | 1   | 99-08 | F81Z-7177-AA  | TC271-185    |
| C124  | Gear, sprocket driven                               | 1   | 99-08 | AE            | TC271-185-R  |
| D131  | Housing, front case NV273                           | 1   | 99-08 | n/a           | TC273F-210   |
| D131  | Housing, front case NV273                           | 1   | 99-08 | AE            | TC273F-210-R |
| D147  | Housing, rear case NV273                            | 1   | 99-08 | n/a           | TC273F-220   |
| C147  | Housing, rear case NV273                            | 1   | 99-08 | AE            | TC273F-220-R |
| D148  | Housing, rear extension NV273                       | 1   | 99-08 | AE            | TC271F-223-R |
| <b>TRANSFER CASE CHAINS</b>                     |   |     |       |               |              |
| B165  | Chain, drive 98 links 1.500" wide (RP) NV273        | 1   | 99-08 | F81Z-7A029-AA | HV-064       |
| <b>ELECTRICAL COMPONENTS</b>                    |   |     |       |               |              |
| D177  | Motor, electric shift NV273                         | 1   | 99-08 | YC3Z-7G360-AA | 600-805      |
| <b>SHIFT FORKS AND PADS</b>                     |   |     |       |               |              |
| D190  | Pad, fork (nylon) NV273                             | 1   | 03-08 | NV37284       | TC261-28     |
| D191  | Pad, fork (nylon) range (ends)                      | 2   | 99-02 | F81Z-7C430-BA | 04167969     |
| D192  | Pad, fork (nylon) range (center)                    | 1   | 99-02 | F81Z-7C430-DA | 04338376     |
| D193  | Fork, range shift (iron) stamped steel              | 1   | 99-02 | IC3Z-7A082-BA | TC241D-123   |
| D193  | Fork, range shift NV273                             | 1   | 03-08 | n/a           | TC271D-123   |
| D195  | Pad, fork (nylon) mode (ends)                       | 1   | 99-08 | 04167969      | 04167969     |
| D197  | Pad, fork (nylon) mode (center)                     | 1   | 99-08 | F81Z-7C430-EA | 04219073     |
| D199  | Fork, mode shift NV273                              | 1   | 99-08 | F81Z-7289-AA  | TC271-124    |
| <b>NOTES</b>                                    |   |     |       |               |              |
|   |   |     |       |               |              |
|   |   |     |       |               |              |
|   |   |     |       |               |              |
|   |   |     |       |               |              |

NV273F



# Dana 20F

Dana 20F

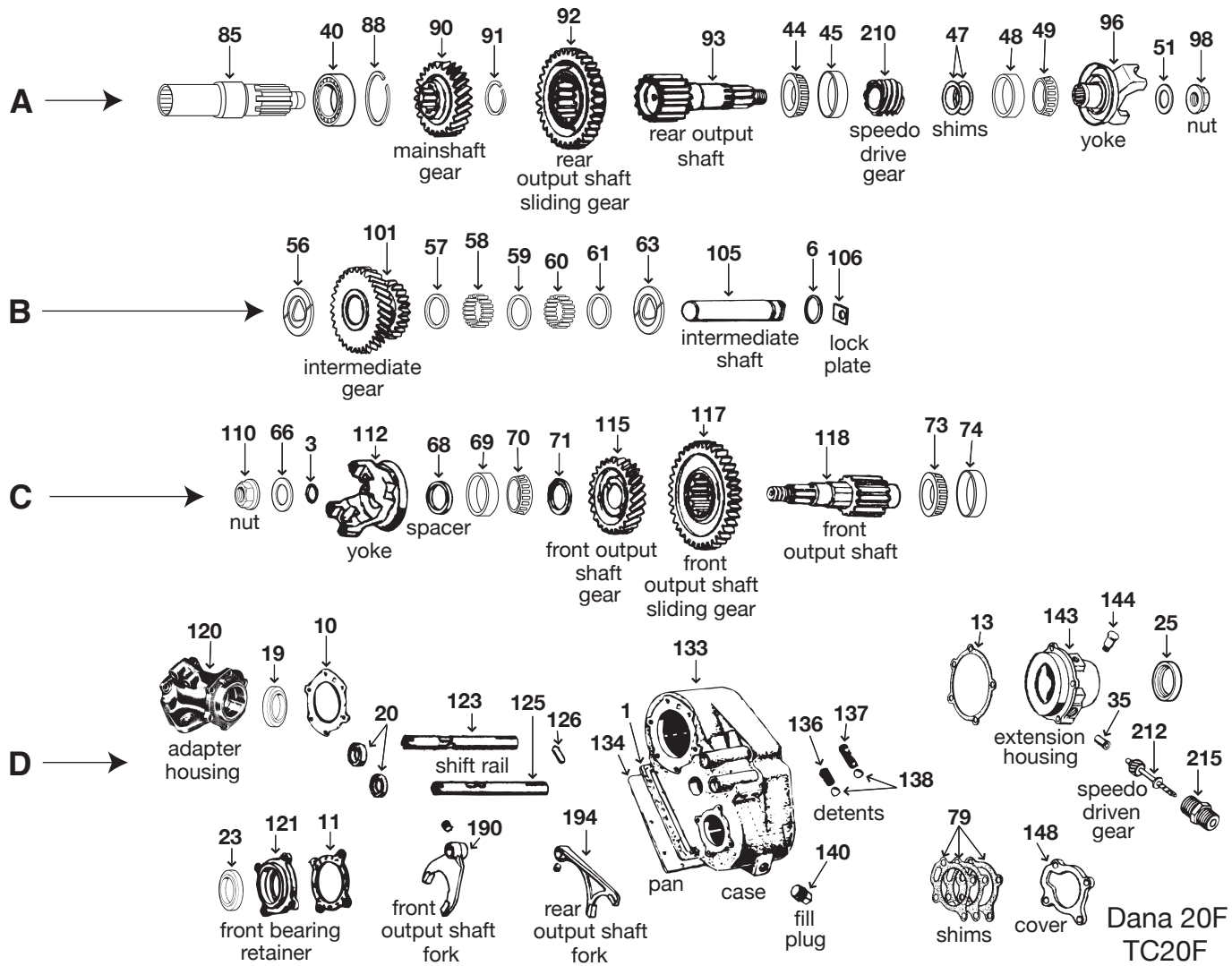

Dana 20F  
TC20F

| ILL                                 | DESCRIPTION                             | QTY | YEAR  | REFERENCE #  | PART #    |
|-------------------------------------|---|-----|-------|--------------|-----------|
| <b>REBUILDER KITS</b>               |   |     |       |              |           |
| n/i                                 | Kit, bearing/gasket/seal Dana 20        | 1   | 66-72 | AE           | TK-20B    |
| n/i                                 | Kit, bearing/gasket/seal Dana 20        | 1   | 73-77 | AE           | TK-20C    |
| n/i                                 | Kit, gasket/seal Dana 20                | 1   | 72-77 | AE           | K105-918  |
| <b>METAL CLAD SEALS</b>             |   |     |       |              |           |
| D19                                 | Seal, metal clad front input shaft      | 1   | 72-77 | C6TZ-7B215-C | 205-18676 |
| D23                                 | Seal, metal clad front output shaft     | 1   | 72-77 | D2TZ-7B2A5-B | 205-15450 |
| D25                                 | Seal, metal clad rear output shaft      | 1   | 72-74 | D2TZ-7B215-B | 205-15450 |
| D25                                 | Seal, metal clad rear output shaft      | 1   | 75-77 | D7TZ-7B215-A | 205-15635 |
| <b>WASHERS/BEARINGS/RACES/SHIMS</b> |   |     |       |              |           |
| A40                                 | Bearing, ball .825" 3.145" od 1.378" id | 1   | 72-77 | E1ZZ-7065A   | 6307N     |
| A44                                 | Bearing, tapered (cup)                  | 1   | 72-77 | n/a          | 25821     |
| A45                                 | Bearing, tapered (cone)                 | 1   | 72-77 | F6ZZ-7065-AA | 25877     |
| A48                                 | Bearing, tapered (cup)                  | 1   | 72-77 | n/a          | 25821     |
| A49                                 | Bearing, tapered (cone)                 | 1   | 72-77 | F6ZZ-7065-AA | 25877     |
| C69                                 | Bearing, tapered (cup)                  | 1   | 72-77 | n/a          | 25821     |
| C70                                 | Bearing, tapered (cone)                 | 1   | 72-77 | F6ZZ-7065-AA | 25877     |
| C73                                 | Bearing, tapered (cone)                 | 1   | 72-77 | F6ZZ-7065-AA | 25877     |
| C74                                 | Bearing, tapered (cup)                  | 1   | 72-77 | n/a          | 25821     |

**NOTES**

# Transfer Case Adapter Gaskets

Transfer Case Adapter Gaskets

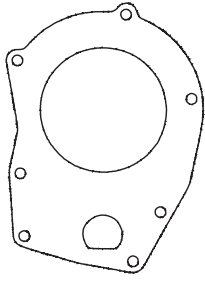

**13590**

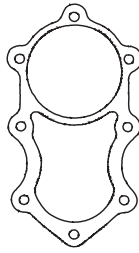

**13592A**

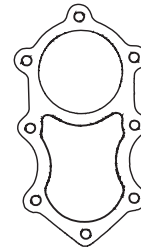

**13592**

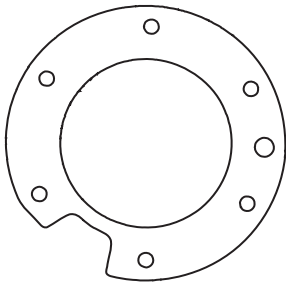

**13591**

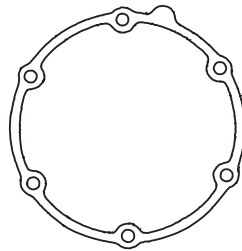

**13589**

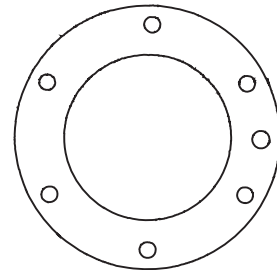

**13593**

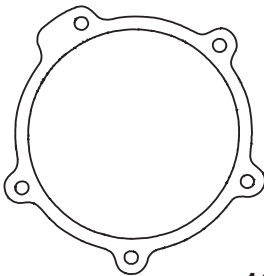

**13595**

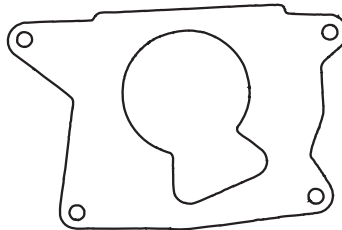

**13596**

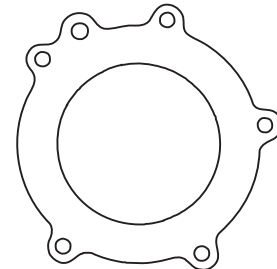

**13594**

| DESCRIPTION                          |  | Qty | Year    | PART #        |
|--------------------------------------|--|-----|---------|---------------|
| <b>TRANSFER CASE ADAPTER GASKETS</b> |  |     |         |               |
| Gasket, transfer case adapter        | NP203 - CHEVROLET/GMC, DODGE                   | 1   | 1969-79 | <b>13590</b>  |
| Gasket, transfer case adapter        | NP205 - CHEVROLET/GMC, (w/o TH400) FORD, DODGE | 1   | 1969-Up | <b>13592</b>  |
| Gasket, transfer case adapter        | NP205 - CHEVROLET/GMC, (w/TH400)               | 1   | 1979-Up | <b>13592A</b> |
| Gasket, transfer case adapter        | NP203/NP205 - FORD (w/direct mounting)         | 1   | 1974-Up | <b>13591</b>  |
| Gasket, transfer case adapter        | NP208/NP241 - CHEVROLET/GMC                    | 1   | 1980-Up | <b>13589</b>  |
| Gasket, transfer case adapter        | NP208/BW1345/BW1356 - AMC, DODGE, FORD         | 1   | 1980-Up | <b>13593</b>  |
| Gasket, transfer case adapter        | NP207/NP231 - CHEVY/GMC "S" SERIES w/TH700-R4  | 1   | 1983-Up | <b>13595</b>  |
| Gasket, transfer case adapter        | BW QUADRATRAC - JEEP (except CJ series)        | 1   | 1974-79 | <b>13596</b>  |
| Gasket, transfer case adapter        | BW1350 - FORD                                  | 1   | 1980-Up | <b>13594</b>  |
|                                      |  |     |         |               |
|                                      |  |     |         |               |
|                                      |  |     |         |               |
|                                      |  |     |         |               |
|                                      |  |     |         |               |
|                                      |  |     |         |               |
|                                      |  |     |         |               |
|                                      |  |     |         |               |

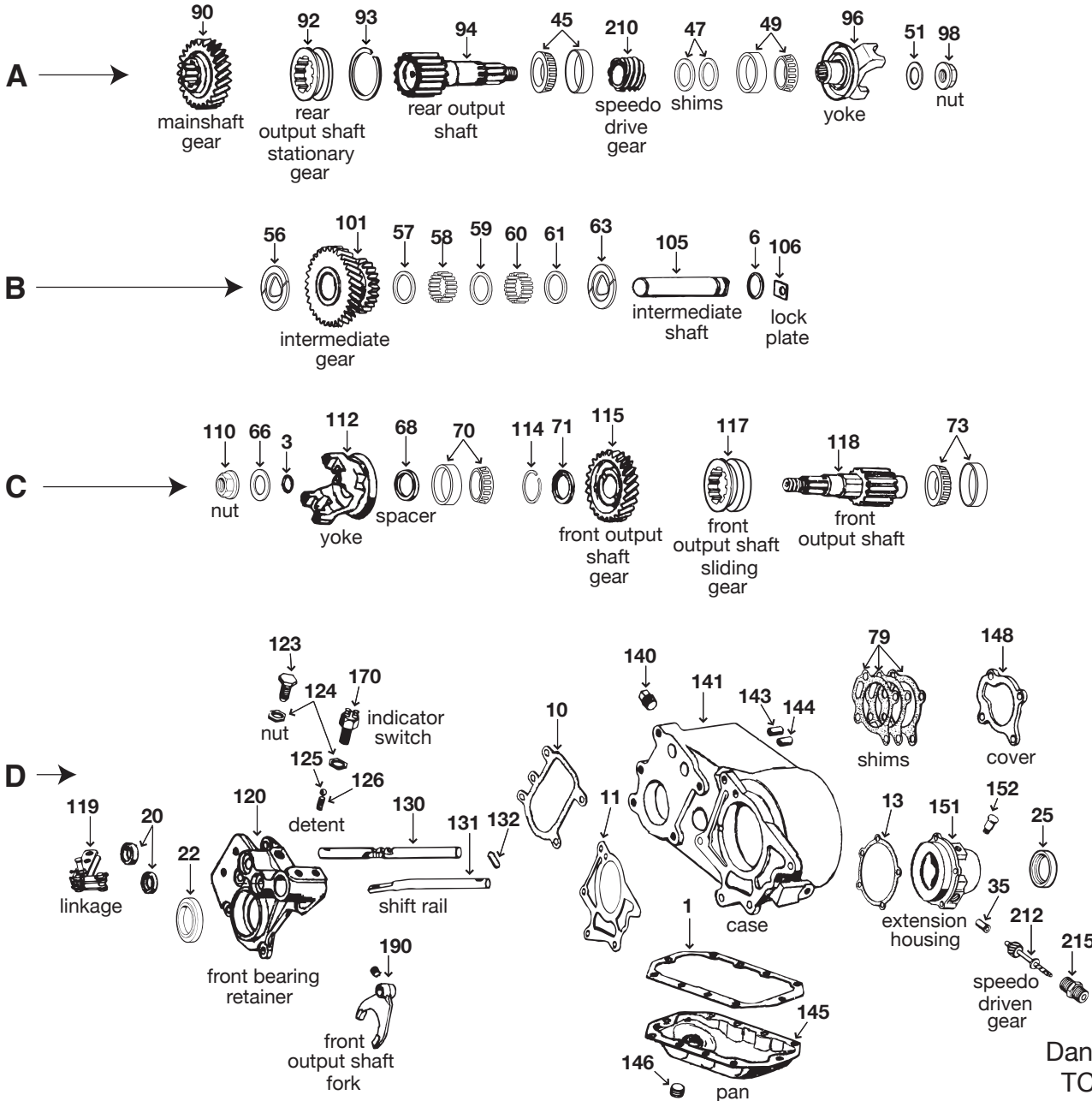

Dana 21  
TC21

| ILL                                 | DESCRIPTION   | QTY | YEAR  | REFERENCE # | PART #           |
|-------------------------------------|---|-----|-------|-------------|------------------|
| <b>REBUILDER KITS</b>               |   |     |       |             |                  |
| n/i                                 | Kit, bearing/gasket/seal Dana 21                        | 1   | 74-76 | TCRK-21     | <b>TK-21</b>     |
| n/i                                 | Kit, gasket/seal Dana 21                                | 1   | 74-76 | DTK-21      | <b>K105-985</b>  |
| <b>METAL CLAD SEALS</b>             |   |     |       |             |                  |
| D20                                 | Seal, metal clad shift shaft                            | 2   | 74-76 | 6203        | <b>205-6203</b>  |
| D22                                 | Seal, metal clad front output shaft                     | 1   | 74-76 | 15450       | <b>205-15450</b> |
| D25                                 | Seal, metal clad rear output shaft                      | 1   | 74-76 | 15699       | <b>205-15699</b> |
| <b>WASHERS/BEARINGS/RACES/SHIMS</b> |   |     |       |             |                  |
| A45                                 | Bearing, tapered (cone) rear output shaft (front)       | 1   | 74-76 | 25877       | <b>25877</b>     |
| A45                                 | Bearing, tapered (cup) rear output shaft (front)        | 1   | 74-76 | 25821       | <b>25821</b>     |
| A49                                 | Bearing, tapered (cone) rear output shaft (rear)        | 1   | 74-76 | 25877       | <b>25877</b>     |
| A49                                 | Bearing, tapered (cup) rear output shaft (rear)         | 1   | 74-76 | 25821       | <b>25821</b>     |
| C70                                 | Bearing, tapered type (cup) front output shaft (front)  | 1   | 74-76 | 14131       | <b>14131</b>     |
| C70                                 | Bearing, tapered type (cone) front output shaft (front) | 1   | 74-76 | 14276       | <b>14276</b>     |
| C73                                 | Bearing, tapered type (cone) front output shaft (rear)  | 1   | 74-76 | 14276       | <b>14276</b>     |
| C73                                 | Bearing, tapered type (cup) front output shaft (rear)   | 1   | 74-76 | 14131       | <b>14131</b>     |



# DanaModel-28

DanaModel-28

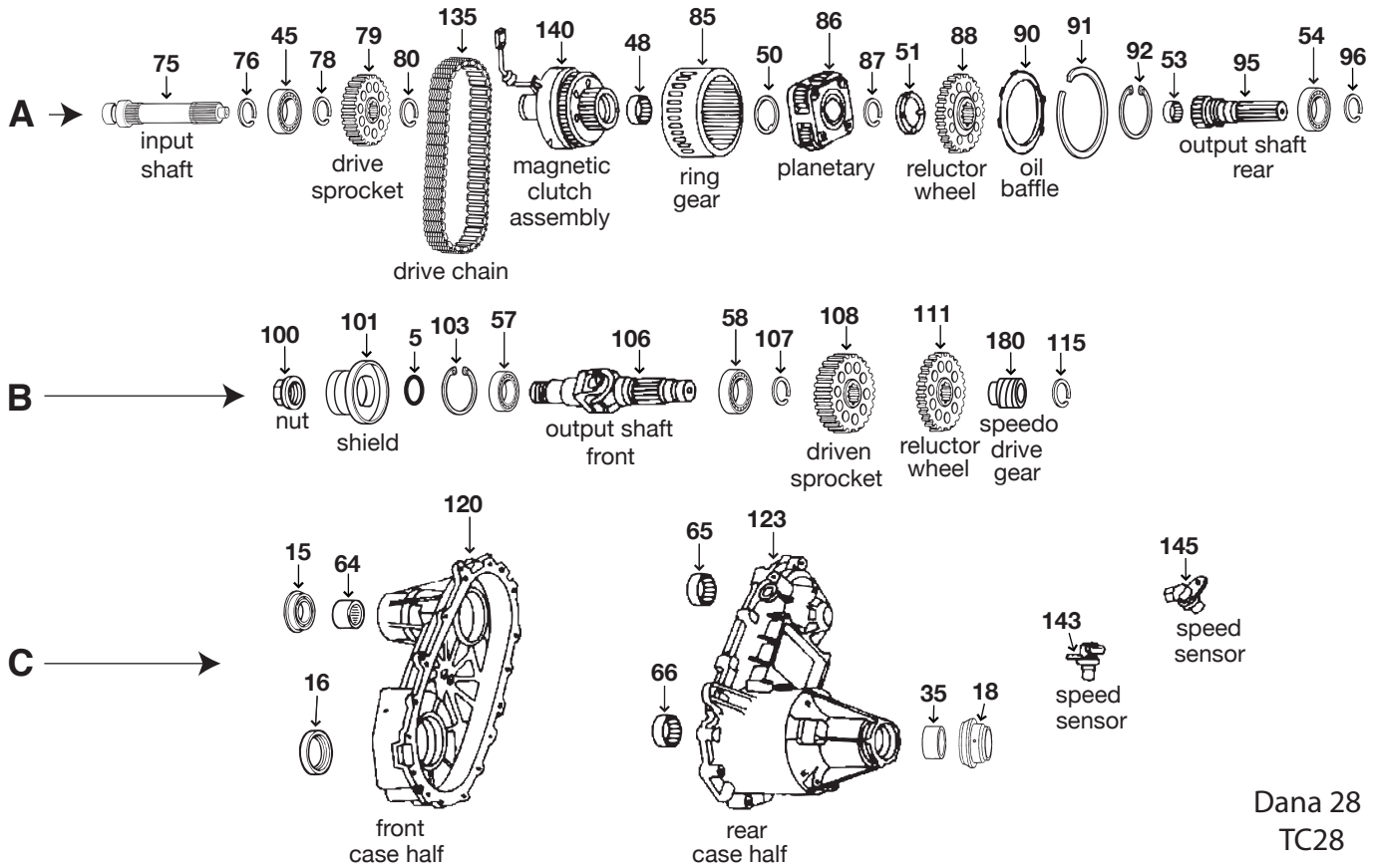

Dana 28  
TC28

| ILL                                  | DESCRIPTION   | QTY | YEAR  | REFERENCE #  | PART #            |
|--------------------------------------|---|-----|-------|--------------|-------------------|
| <b>REBUILDER KITS</b>                |   |     |       |              |                   |
| n/i                                  | Kit, bearing/gasket/seal Dana 28                                    | 1   | 90-97 | AE           | <b>TK-28</b>      |
| n/i                                  | Kit, gasket/seal Dana 28  | 1   | 90-97 | AE           | <b>K105-917</b>   |
| <b>GASKETS AND RUBBER COMPONENTS</b> |   |     |       |              |                   |
| n/i                                  | Gasket, adapter Dana 28   | 1   | 90-97 | M353317A     | <b>13594</b>      |
| <b>METAL CLAD SEALS</b>              |   |     |       |              |                   |
| C15                                  | Seal, metal clad front output shaft                                 | 1   | 90-97 | F09Z-7B215-A | <b>205-18623</b>  |
| C16                                  | Seal, metal clad front input shaft                                  | 1   | 90-97 | F09Z-7B215-B | <b>205-17353</b>  |
| C18                                  | Seal, metal clad rear output shaft                                  | 1   | 90-97 | n/a          | <b>205-14978</b>  |
| <b>BUSHINGS</b>                      |   |     |       |              |                   |
| C35                                  | Bushing .935" 1.510" id 1.665" od extension housing                 | 1   | 90-97 | n/a          | <b>TC28-162</b>   |
| <b>WASHERS/BEARINGS/RACES/SHIMS</b>  |   |     |       |              |                   |
| A45                                  | Bearing, ball .747" 3.344" od 1.772" id front input shaft (front)   | 1   | 90-97 | F09Z-7065-A  | <b>6209N</b>      |
| A48                                  | Bearing, caged .620" 1.311" id 1.630" od input shaft (rear)         | 1   | 90-97 | B-2110       | <b>TC28-135</b>   |
| A54                                  | Bearing, ball .747" 3.344" od 1.772" id rear output shaft (front)   | 1   | 90-97 | F09Z-7025-A  | <b>6209N</b>      |
| B57                                  | Bearing, ball .590" 1.573" id 2.675" od front output shaft (front)  | 1   | 90-97 | F09Z-7118-A  | <b>6008-J</b>     |
| B58                                  | Bearing, ball .747" 3.344" od 1.772" id front output shaft (middle) | 1   | 90-97 | F09Z-7025-A  | <b>6209N</b>      |
| C65                                  | Bearing, caged .620" 1.311" id 1.630" od front output shaft (rear)  | 1   | 90-97 | B-2110       | <b>TC28-135</b>   |
| C66                                  | Bearing, caged .620" 1.311" id 1.630" od rear output shaft (rear)   | 1   | 90-97 | B-2110       | <b>TC28-135</b>   |
| <b>HARD PARTS</b>                    |   |     |       |              |                   |
| A75                                  | Shaft, input Dana 28  | 1   | 90-97 | F09Z-7017-A  | <b>TC28-172-R</b> |
| A79                                  | Gear, drive sprocket Dana 28  | 1   | 90-97 | F09Z-7177-A  | <b>TC28-175-R</b> |
| A85                                  | Gear, ring Dana 28  | 1   | 90-97 | F09Z-7A385-A | <b>TC28-178-R</b> |
| A86                                  | Gear, planetary Dana 28   | 1   | 90-97 | F09Z-7A398-A | <b>TC28-180-R</b> |
| A88                                  | Gear, reluctor wheel 64T Dana 28                                    | 1   | 90-97 | F09Z-7G450-A | <b>TC28-183-R</b> |
| A95                                  | Shaft, rear output Dana 28  | 1   | 90-97 | F09Z-7061-A  | <b>TC28-187-R</b> |
| B100                                 | Nut, front output shaft Dana 28                                     | 1   | 90-97 | AE           | <b>TC28-190-R</b> |
| B101                                 | Shield, front output shaft Dana 28                                  | 1   | 90-97 | F09Z-7C016-A | <b>TC28-191-R</b> |





T-1256

